

# PURITY

BY RICHMOND FURNITURE

## WELCOME TO PURITY

*Great British Furniture Since 1987* 

t: 01457 767000

e: **purity xpress** [purity.xpress@richmond-furniture.co.uk](mailto:purity.xpress@richmond-furniture.co.uk)

**purity portfolio** [orders@richmond-furniture.co.uk](mailto:orders@richmond-furniture.co.uk)

w: [www.richmond-furniture.co.uk](http://www.richmond-furniture.co.uk)

Richmond Furniture Ltd, Regent House,  
Hadfield Industrial Estate, Waterside,  
Hadfield, Glossop SK13 1BS

Richmond  
 FURNITURE



# CONTENTS

03	Welcome to Purity	27	Purity Xpress Delivery Service
04	Facts and Figures	28	Introduction to Purity Portfolio
05	Why Purity?	29	Purity Portfolio Door Collection
06	Your Contacts	31	Purity Portfolio Cabinet Collection
07	Our Design & Estimating Support	32	Purity Portfolio Laminate Surface Collection
08	Our New Order Process	33	Purity Portfolio Compact Laminate Surface Collection
09	Our Confirmation Procedure	34	Purity Portfolio Deklite Surface Collection
10	Our Price Files	35	Purity Portfolio Solid Acrylic Surface Collection
11	Our Samples	36	Purity Portfolio Solid Quartz Surface Collection
12	Our After Sales Support	38	Purity Portfolio Dekton Surface Collection
13	Our New Concept: Vicino	39	Purity Portfolio Handle Collection
14	Our Brochures	40	Purity Portfolio Range Content
15	Introduction to Purity Xpress	47	Purity Portfolio Delivery Service
16	Purity Xpress Door Collection	48	Our Useful Documents
17	Purity Xpress Cabinet Collection	54	Our Important Bits
18	Purity Xpress Surface Collection	57	Our Small Print
19	Purity Xpress Handle Collection	58	Our Product
20	Purity Xpress Range Content	55	Welcome on Board
23	Purity Vicino Range Content		

# PURITY

BY RICHMOND FURNITURE



# WELCOME TO PURITY

A warm welcome to **Purity by Richmond Furniture**.

Let us share a little about **Richmond Furniture**.

*With over 35 years experience working in partnership with the UK's Private Developers, Trade Merchants, Public Sector Clients, Purpose Built Student Accommodation Providers, Built To Rent Specialists and Retailers – you are in safe hands.*

We are a privately owned British manufacturer of fitted furniture. We manufacture right here in the UK from our 90,000 square foot facility in Hadfield, Derbyshire, some 13 miles from Manchester. The importance of reliable supply has never been more critical.

We have developed a reputation for producing quality backed goods with first class service support. A brand trusted by our customers, a brand with a long and rich history.

Its imperative to us that we develop a reliable but personalised service for our customers. This starts here with our **Welcome to Purity** brochure.

**Purity by Richmond Furniture** is our specialist brand for the Merchant and Independent Kitchen Market. The **Purity** brand is a range of high quality furniture built to

the most exacting standards. We have two exciting collections for your consideration: **Purity Xpress** and **Purity Portfolio**.

**Purity Xpress** is a collection of 11 ranges available on our Xpress service. All of these ranges are offered on our guaranteed postcode delivery service: order Week 1 for delivery Week 2.

**Purity Portfolio** is a wider collection of 23 ranges available on our order Week 1 for delivery Week 4 service. Our PG8, PG9 and PG10 painted product on our order Week 1 for delivery Week 5 service.

Why not take advantage of our vast experience? Experience matter and we know what you need. We understand the importance of developing a range of furniture that both looks magnificent and performs in the same way.

This document outlines all you need to know to help you get started. If you have any questions don't hesitate to contact our team.

**Purity by Richmond Furniture** - over 35 years of doing what we say we will.

- The Richmond Directors

A MANUFACTURER  
OF FURNITURE,  
NOT A DISTRIBUTOR  
OF FURNITURE

## FACTS & FIGURES

### BOARD TO BOX... AND DOORS

Richmond Furniture are a true furniture manufacturer converting raw board to fully installed quality furniture pieces.



FOUNDED  
1987



120+ STAFF  
MEMBERS



90,000 SQ FT  
FACTORY



SHOWROOM



TRAINING  
HUB



CABINET  
MANUFACTURER



50 KITCHENS  
PER DAY



50,000 PANELS  
WEEKLY



110,000 UNITS  
ANNUALLY

6

6 FURNITURE  
BRANDS

# WHY PURITY?



- Great British furniture since 1987 – experience matters
- Our product is proudly manufactured right here in Great Britain – reliability matters
- We are a manufacturer of kitchen furniture not a distributor, buy direct and remove the distributor's margin – price matters
- Our company is ISO14001 & ISO9001 accredited – accreditation matters
- All products are FSC certified, we care for our environment, and we know you do too – the planet matters
- Our great product is installer friendly and supplied fully rigid (including our tall housings). All doors are attached and internal accessories factory installed – making it easy matters #1
- Delivery will be FOC – convenience matters
- All product delivered with bespoke packaging as standard – protection against damage matters
- Plan checking service available for all first orders – help matters
- Estimating service for all projects of 10 or more plots – taking the strain matters
- Purity by Richmond Furniture offer something unique, we provide a 'dry fit' installation service to all Richmond fleet delivery postcodes providing the project is 10 or more plots – installation matters
- Comprehensive display stands and samples available – looking good matters
- 5 year guarantee on all furniture – peace of mind matters

## WHY PURITY XPRESS?

- Purity Xpress brochure and price list available
- Purity Xpress product manual available
- Rigid kitchen delivery by working day 6
- Guaranteed postcode delivery day so you will always know your delivery date at point of order #2
- Remedial fast track service by carrier or postcode guaranteed delivery service (stock dependant)
- 2020 - A Cyncl Company, Artcad and KBB Connect ready
- 18mm fully rigid cabinet
- Premier Drawer Box as standard with a load capacity of 30kg
- 11 ranges and 38 frontals to choose from
- 14 super priced 18mm MFC slabs
- Our new Vicino near handleless collection available in all our ranges
- Colour or frontal matched gables available, no need for expensive plant on panels
- Worktops available in 1000mm, 2000mm, 3000mm & 4000mm lengths #3
- Premier Plus Drawer Box with soft close and clip on soft close hinge option
- Frontal matched or colour matched plant on panel option (Dese, Dunedin, Downey, Farnborough & Geneve are matt colour matched, all other ranges frontal matched)

## WHY PURITY PORTFOLIO?

- Purity Portfolio brochure and price list available
- Purity Portfolio product manual available
- Rigid kitchen delivery – order Week 1 for delivery Week 4 #4
- Your actual day of delivery confirmed the week prior to delivery
- Artcad and KBB Connect ready
- Remedial service, order Week 1 for delivery Week 2 (stock dependant)
- 18mm fully rigid cabinet
- Premier Deluxe Drawer Box soft close and all doors soft close
- Premier Plus Drawer Box with soft close economy option
- 23 ranges and 95 colours available
- Our London Linear true handleless collection available in all our ranges
- Worktops available in 38mm with 3mm tight radius or 22mm and 38mm square edged
- Frontal matched plant on panels as standard #5

#1 Due to their weight and height, the following units are supplied ready to assemble to allow easier access for delivery to your customer: 950mm 'L' shape corner base, 1000mm larder, any cross corner larder & pantry units.  
#2 Our 'Order Week 1 for delivery Week 2' service is based on you placing your order for less than 2 kitchens and prior to agreed cut-off. If 3 or more kitchens are ordered, our 'Order Week 1 for delivery Week 3' service will apply.  
#3 Worktops can only be ordered for deliveries on RICHMOND FLEET postcodes - worktops are not available on PALLETISED DELIVERIES.  
#4 Our PG8, PG9 & PG10 painted product available on a slightly extended lead time. Order Week 1 for delivery Week 5 service.  
#5 Our Downey range will come with colour matched plant on panels not frontal matched.

# YOUR CONTACTS

## SALES OFFICE

Our Sales Office is here to help you. We can assist with order placement and amendments. Should you have a technical query you can submit to the Sales Office who will direct your enquiry as appropriate. All orders, including amends, must be submitted by email.

Telephone **01457 767000**

*Order placement and order information*

Xpress Orders **[purity.xpress@richmond-furniture.co.uk](mailto:purity.xpress@richmond-furniture.co.uk)**

Portfolio Orders **[orders@richmond-furniture.co.uk](mailto:orders@richmond-furniture.co.uk)**

*Technical and general queries*

Email **[customer.service@richmond-furniture.co.uk](mailto:customer.service@richmond-furniture.co.uk)**

## DESIGNS & ESTIMATES

In the event you need to discuss your quotation or design, please contact our estimating team.

Telephone **01457 767000**

Email **[estimating@richmond-furniture.co.uk](mailto:estimating@richmond-furniture.co.uk)**

## CREDIT CONTROL

If you have a credit account, please use the following point of contact for payments, account queries or account limits.

*All account queries*

Telephone **01457 767054**

Email **[credit.admin@richmond-furniture.co.uk](mailto:credit.admin@richmond-furniture.co.uk)**

## RICHMOND FURNITURE LIMITED

Company Number **11723196**

VAT Number **311 0458 55**

Showroom / Factory Address **Regent House, Hadfield Industrial Estate, Waterside, Hadfield Glossop, SK13 1BS**

## ACCOUNT MANAGERS



**Niamh Flanagan**

07464 784512

[niamh.flanagan@richmond-furniture.co.uk](mailto:niamh.flanagan@richmond-furniture.co.uk)



**Norrie MacLeod**

07467 822941

[norrie.macleod@richmond-furniture.co.uk](mailto:norrie.macleod@richmond-furniture.co.uk)



**Kerry Dowling**

07918 200889

[kerry.dowling@richmond-furniture.co.uk](mailto:kerry.dowling@richmond-furniture.co.uk)

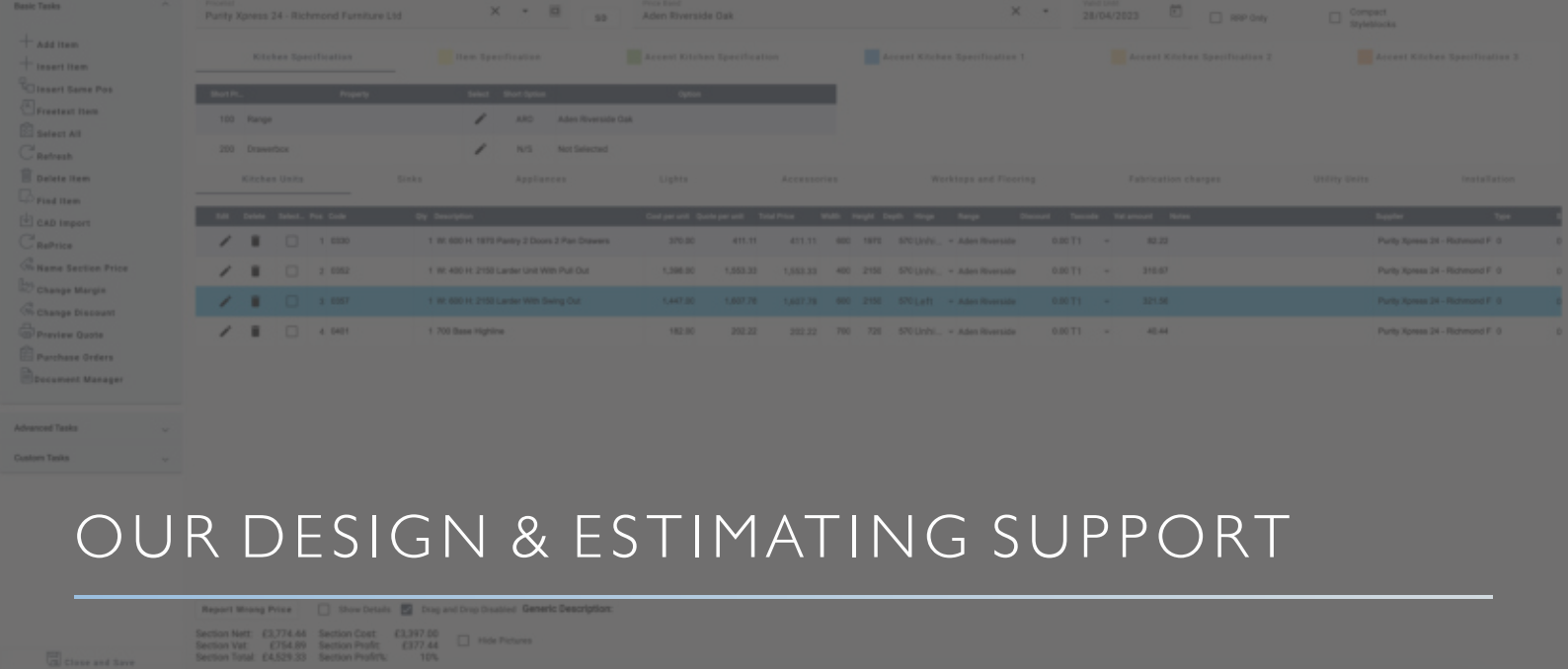

# OUR DESIGN & ESTIMATING SUPPORT

Your Purity catalogues are ready to use on these three great platforms.

## OUR CATALOGUES ARE PRELOADED ON



### ARTICAD

- The software we use to design your kitchens, bedrooms and other interiors
- Helps to win sales and manage installations
- Deliver an exceptional customer experience online, in-store and in-home
- Improvements made based on customer feedback, making it easier for you to sell
- Speedy and flexible software
- Create visually stunning and accurately detailed design presentations for your clients in just a few minutes



### KBB CONNECT

- Work faster and smarter
- Online quoting, ordering and project management service provides real time pricing data direct from KBB suppliers
- New tools provide enhanced functionality - incorporating financial processing, good management, remedial tracking and much more
- Run your business even more profitably



### 2020 - A CYNCLY COMPANY

- Bring ideas to life, inspire innovation and streamline processes.
- End-to-end software solutions that help put consumers at the heart of the business
- Cyncl Solutions serve over 70,000 customers globally helping to simplify communication, reduce errors, grow sales, increase efficiency and drive innovation

Let us take the strain for you, with some great free services.

- **Design and estimate check service.** On all client first orders, we will happily check your completed design and estimate prior to processing the order. We will just need an extra 48 hours to allow us to do so.
- **Design and estimate service.** If your project is 10 plots or more we will be happy to provide the design and estimate for you. If you wish to use this service please fill out our Quotation Request Form (refer to example on page 44) and allow 15 working days for completion.

# OUR NEW ORDER PROCESS

Now to the exciting part – the placing of your order for your new Purity kitchen. You have 3 ways to place your order:

## By KBB Connect

It's all so simple but if you are not familiar with the portal we will be happy to organise an induction session

## By Inventory List

You provide the details of your requirements and we will process your order\*

## By Ordering

from a design and estimate package provided by Purity by Richmond Furniture\*\*

*\*You can find details of all available units on: Purity Xpress (pages 20 - 22) & Purity Portfolio (pages 31 - 37)*

*\*\*REMEMBER we only offer this service for projects 10 plots or greater*

## WHAT WE NEED YOU TO DO FOR US

All orders should be sent to our Orders Team by email.

- 💧 Purity Xpress orders to **purity.xpress@richmond-furniture.co.uk**
- 💧 Purity Portfolio orders to **orders@richmond-furniture.co.uk**

We would like to process your order both swiftly and accurately for you. To help us to do so, the following information will be required:

- 💧 Customer Invoice Address
- 💧 Customer Delivery Address *(if delivery is not to your default delivery address, please complete our kerbside delivery form - refer to example on page 40)*
- 💧 Purchase Order Values
- 💧 Kitchen Range
- 💧 Kitchen Colour
- 💧 Carcase Type
- 💧 Carcase Colour *(Series | 2WO and Vicino available White or Onyx. Series | 3HREE available White, Onyx or Oak and Series | 4OUR available White or Onyx)*
- 💧 Drawer Box Type *(Series | 2WO available in Premier or Premier Plus drawer box. Series | 3HREE and Series | 4OUR available in Premier Deluxe drawer box as standard, with economy option of Premier Plus)*
- 💧 Drawer Box Colour *(Premier available in White. Premier Plus available in Anthracite. Premier Deluxe available in Anthracite)*
- 💧 Products and Quantity Requirements
- 💧 Confirmation of Unit Hanging
- 💧 Confirmation of Gable Hanging
- 💧 Purchase Order Number

## WHAT WE WILL DO FOR YOU

- 💧 On all first orders received, we will happily check both your plan and estimate for accuracy. If you wish us to do so please provide a copy of your plan and estimate with your order requesting this check takes place. Please allow an additional 48 hours for the this service.
- 💧 If your project is 10 plots or greater we will be happy to provide the design and estimate for you. If you wish to use this service please fill out our Quotation Request Form (refer to example on page 44) and allow 15 working days for completion.
- 💧 No matter the method of ordering we will send you a detailed order confirmation for checking.

## REMEMBER TO ALWAYS

- 💧 Check your order confirmation to ensure we are processing exactly what you are expecting.
- 💧 Check your delivery immediately upon receipt. If any of the packaging is not in perfect condition, sign as damaged while you further investigate the goods. If anything is damaged upon inspection, let our office know promptly upon delivery but no later than 5 working days following delivery.
- 💧 When placing your order based on a design and estimate completed by Purity by Richmond Furniture always ensure you have verified the plan and listing provided by us. Ensure you order using our Purity by Richmond Furniture Call Off Sheet (refer to example on page 43) and complete in full.



# OUR CONFIRMATION PROCEDURE

---

## PURITY XPRESS

With our guaranteed postcode delivery day you will already know the day of delivery when you place your order, so that's easy. Within 24 hours, our Orders Team will provide confirmation of your order.

## PURITY PORTFOLIO

Our standard lead time on our Purity Portfolio is order Wednesday Week 1 by 10am for delivery in Week 4. We promise to keep you informed of progress weekly with our new delivery confirmation notice which includes a Week 2, Week 3 & Week 4 schedule. Our PG8, PG9 & PG10 painted product on our order Week 1 for delivery Week 5 service.



Each week our customers receive an automated delivery schedule confirming all orders we have for them in our system.

### Week 2 Delivery Schedules

**NO ACTION REQUIRED** At this stage, it is no longer possible to amend your Week 2 scheduled orders. These are now in production following your previous acceptance of the scheduled delivery. Our email is simply to confirm the actual day of delivery.

### Week 3 Delivery Schedules

**ACTION REQUIRED** We require email confirmation that you will be ready for the week commencing date confirmed. If we do not receive positive confirmation by 12pm on the Thursday of the week, the delivery schedule is issued.

### Week 4 Delivery Schedules

**NO ACTION REQUIRED** We do not require you to confirm or amend dates at this time. This schedule is simply to make you aware of all of your scheduled deliveries beyond the Week 2 and Week 3 scheduled deliveries.

# OUR PRICE FILES

Our two price files are available to download at your convenience, so feel free to do so.



## PURITY XPRESS

Link coming soon



## PURITY PORTFOLIO

Link coming soon



# OUR SAMPLES

\*Prices shown do not include VAT.

We sell great products and understand the importance of making sure these are presented in the right way to your clients. This is why we offer such a wide variety of sample options, you are sure to find one that suits your needs perfectly.

## XPRESS SAMPLE DISPLAY

Size: W 873mm x H 2120mm x D 595mm

Includes 35 spaces,  
35 doors excluding Dese (570mm x 396mm, SD218),  
1 handle sample board of Purity Xpress handles  
(570mm x 396mm) & 12 worktops from PG2  
(190mm x 135mm)

SAI149

£249\* (inc doors)



## PORTFOLIO DISPLAY MODULE

Size: W 1200mm x H 2120mm x D 595mm

Includes 27 spaces, 24 doors (570mm x 396mm,  
SD218), 3 handle sample boards (570mm x 396mm),  
32 sample drawers (140mm x 396mm, SD203),  
20 worktops from PG2 & PG4  
(190mm x 135mm)

SAI034

£249\* (inc doors)



## DISPLAY MODULE 2

Size: W 610mm x H 2120mm x D 330mm

Includes 20 spaces, 18 doors  
(570mm x 396mm, SD218),  
2 handle sample boards  
(570mm x 396mm)

SAI032

£199\* (inc doors)



## 6 TO 12 PIECE SWATCH BOARD

Size: W 396mm x H 570mm

Single or double sided samples  
(110mm x 190mm, SD200)  
Max 12 samples per board

SAI058

£50\*



## SAMPLE DOORS

Size: W 396mm x H 570mm

Available in all ranges, painted ranges are  
PTO and require PTO colour added.  
Doors available on 72 hour lead time,  
bar PTO which is 2 weeks

SD218

£10\*



## WORKTOP SAMPLES

PG2 laminate swatch set

Available on 72 hour lead time

SWTPG2BS

FOC



## LARGE HANDLE BOARD

Size: W 570mm x H 792mm  
with 32mm pitch location holes

Handles ordered separately  
(approx 19 handles)

SD792X570H

£25\*



## MINICAB

Size: W 300mm x H 570mm x D 400mm

Includes: Series | 3HREE Premier Deluxe Drawerline  
in Onyx, 18mm MFC Carcass Mini Cab with  
H 140mm Premier Deluxe Top Drawerbox  
D 260mm and 420mm x 296mm bottom door.

SAI088

£50\*

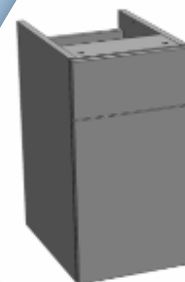

# OUR AFTER SALES SUPPORT

## RECOVERY

- ◆ When something goes wrong we know you need us to resolve it quickly and we will.
- ◆ Email [customer.service@richmond-furniture.co.uk](mailto:customer.service@richmond-furniture.co.uk) or telephone **01457 767000** for help and support.
- ◆ We will organise your replacement parts in line with our remedial delivery commitments.

## DAMAGES & MISSING ITEMS

- ◆ In the event your delivery arrives and any part of the packaging shows signs of damage, please record this on your delivery paperwork as 'packaging damaged on delivery'.
- ◆ Please inspect your goods promptly upon delivery but no later than 5 working days following delivery. This allows us to action swiftly for you.
- ◆ Any missing item should be reported promptly upon delivery but no later than 5 working days following.
- ◆ If you do find any issues following your delivery, please contact our Customer Service Team who will be happy to assist you. Our Customer Service Team will require clear photos of the products involved so please include them in your email.
- ◆ Providing you have reported within the 5 day period following delivery, these will be issued on a FOC basis.
- ◆ We do not require the damaged items to be returned, so please dispose of them responsibly.

## MANUFACTURING FAULTS

- ◆ If you discover a manufacturing fault please report it immediately to our Customer Service Team. Please do this by email, attaching clear photos of the product involved.
- ◆ If we agree that the goods are faultily manufactured, we will issue a replacement on a FOC basis. We do not require to collect the faulty goods so please dispose of these responsibly.
- ◆ In the rare instances that the photos provided do not help us determine the fault, it may be necessary to inspect the goods or have them returned for inspection.

## NO RETURNS

- ◆ We are unable to accept furniture and worktops for return. As a manufacturer of the product, we make to order. As such we operate a no returns policy.
- ◆ All other goods would be checked with the relevant supplier. Should the supplier accept for return, a re stocking charge will likely be applicable. Goods must be returned in the same condition they were delivered.

## 5 YEAR GUARANTEE

Our Purity Xpress & Purity Portfolio ranges are backed by a 5 year warranty against manufacturing defects. Warranty is non-transferrable.

# VICINO

## OUR NEW CONCEPT FOR 2024

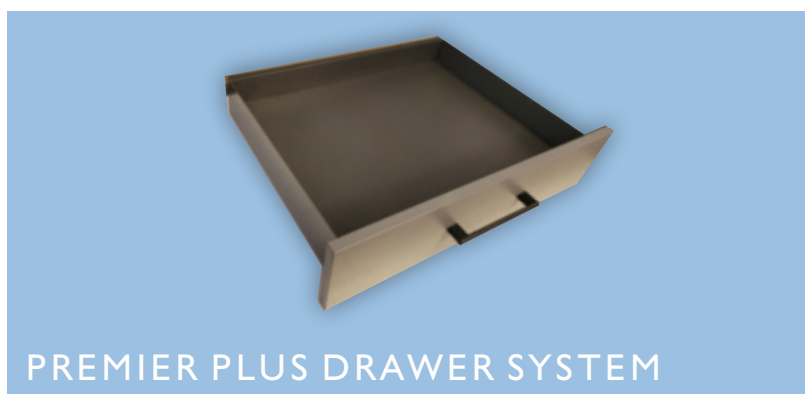

### THE NEW NEAR HANDLELESS SOLUTION

Vicino works on the same design principals as our very successful True Handleless kitchen collection with one important difference: we use IN LINE HANDLES on all Tall Housings.

- On the **Wall Units**, we inset the bottom of the unit to allow you to open without the use of a handle.
- On the **Base Units**, we utilise our attractive rail system in Silver or Anthracite allowing you to open without the use of a handle.
- On the **Tall Housing Units**, we introduce our ultra low profile In Line handles in Silver or Anthracite.

Richmond Furniture - leading the way in innovation: future proof furniture for a changing world.

- A very cost effective near Handleless solution.
- Vicino is available in all our Purity Xpress ranges and colours.
- 11 ranges and 38 colours to choose from.
- Featuring our new Onyx cabinet interior.
- Unlike True Handleless, no need to create multiple designs: Vicino will work with any standard kitchen plan, even one that uses handles.

# OUR BROCHURES

All great kitchens need great brochures and ours do not disappoint. Let our beautiful literature introduce you to our inspiring collections of impressive kitchens. Transform your kitchen, home and life with Purity by Richmond Furniture.



## PURITY PORTFOLIO

Link [tinyurl.com/purityportfolio2024](https://tinyurl.com/purityportfolio2024)



## PURITY XPRESS

Link [tinyurl.com/purityxpress2024](https://tinyurl.com/purityxpress2024)



# PURITY

BY RICHMOND FURNITURE

## INTRODUCTION TO PURITY XPRESS

# PURITY XPRESS DOOR COLLECTION

The quality kitchen at an unbeatable price, all on our guaranteed postcode delivery service. When you need a quick solution, Purity Xpress is the one to rely on.



Your Purity Xpress units come as standard with White or Onyx cabinets. Your visible cabinet ends are therefore White or Onyx. You can, of course, add our Frontal Matched or Colour Matched gable ends should you desire that the visible ends of your cabinet match your kitchen door. Alternatively, you can order our Frontal Matched or Colour Matched plant on panels. The guide below confirms which of our ranges are offered with Frontal Matched or Colour Matched gables and plant on panels.

**FM** **FRONTAL MATCHED** When we use the term 'Frontal Matched' gables or plant on panels, this explains that the gables (sides of your units) or plant on panels (which attach to the visible sides of the units) will be manufactured from the same materials as the kitchen door, creating a 100% match. Your plinth and fillers will also be 'Frontal Matched'.

**CM** **COLOUR MATCHED** When we use the term 'Colour Matched' gables or plant on panels, this explains that the gables (sides of your units) or plant on panels (which attach to the visible sides of the units) will NOT be manufactured from the same materials as the kitchen door, but in a substitute material. Usually, this will be a melamine faced chipboard that matches the colour of the fascia, but not the finish of the door. Your plinth and fillers will also be 'Colour Matched'. **Always** consult Richmond for samples to approve.

# PURITY XPRESS CABINET COLLECTION

Our **SERIES | 2WO** cabinet design offers a contemporary kitchen solution to suit robust designs. Our **SERIES | 2WO** cabinet provides a high level of quality, with the opportunity for you to customise the hinges and drawers to suit your needs.

## SERIES | 2WO AS STANDARD

- ◆ Fully Rigid 18mm MFC Cabinet
- ◆ White or Onyx Interior Cabinet
- ◆ 570mm Deep Base Units
- ◆ 870mm High Base Units (Excludes Worktop)
- ◆ 3mm Hardboard Back Panel
- ◆ 330mm Deep Wall Units
- ◆ Wall Hanging Bracket 3 Way Adjustable
- ◆ 110o Clip On Hinge with Attachment to Covert Hinge to Soft Close
- ◆ Premier Drawer Box in White with Drawer Brake System to Convert to Soft Close
- ◆ Service Gap 67mm on Base Units
- ◆ Service Gap 19mm on Wall Units
- ◆ Frontal Matched Corner Solution

## OPTIONS

- ◆ Premier Plus Soft Close Drawer in Athracite



CABINET  
COLOURS  
AVAILABLE

WHITE

ONYX

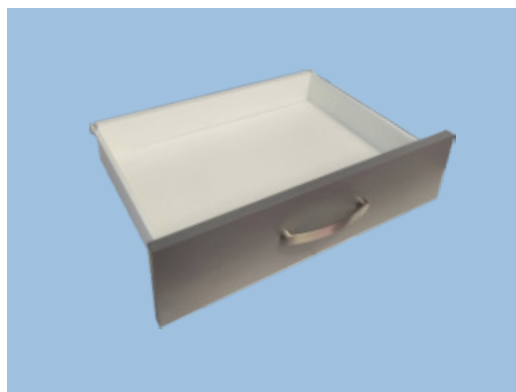

PREMIER  
DRAWER  
SYSTEM  
AVAILABLE

WHITE

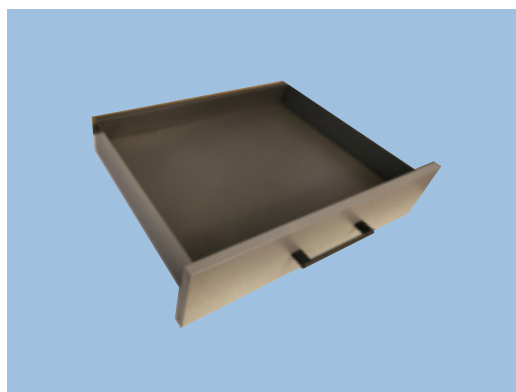

PREMIER  
PLUS  
DRAWER  
SYSTEM  
AVAILABLE

ANTHRACITE



# PURITY XPRESS SURFACE COLLECTION

---

A collection of high pressure laminate surfaces engineered to the best of standards.

BANWELL  
CLOUD

BANWELL  
PEBBLE

BANWELL  
CARAMEL

BANWELL  
SLATE

BEAULY  
TREVISIO

BEAULY  
GRIGIO

BEAULY  
CALCUTTA

BEAULY  
DONTELLO

## PG2 THE PREMIER DELUXE COLLECTION

Things just got a little bit more exciting with our recently launched blend of exotic stones, marbles and wood laminates. Surfaces are 40mm deep with a 3mm radius. Upstand 100mm high, square edge.

BRITT  
BLUSHWOOD

BRITT  
DRIFTWOOD

BRITT  
STORMWOOD

BRITT  
WARMWOOD

# PURITY XPRESS HANDLE COLLECTION

The perfect kitchen needs the perfect handle. We offer an extensive range of kitchen handles in a variety of finishes to let you discover the style and finish which best suits you and your kitchen. Whether an ultra modern finish or something to top off that vintage look, you will be certain to find what you are looking for.



**T BAR**  
Bar Handle Brushed Nickel 185mm  
Handle Centres - 128mm  
H125



**PULL**  
Pull Handle Chrome  
Handle Centres - 128mm  
H179



**D**  
D Handle Copper  
Handle Centres - 160mm  
H286



**KNOB**  
Jude Knob Handle Brushed Brass  
Handle Centres - 0mm  
H287



**KNOB**  
Jude Knob Handle Polished Nickel  
Handle Centres - 0mm  
H288



**KNOB**  
Jude Knob Handle Antique Copper  
Handle Centres - 0mm  
H289



**TAPER**  
Taper Handle Satin  
Handle Centres - 128mm  
H301



**TAPER**  
Taper Handle Chrome  
Handle Centres - 128mm  
H302



**BOW**  
Bow Handle Brushed Nickel  
Handle Centres - 160mm  
H303



**BOW**  
Bar Handle Polished Chrome  
Handle Centres - 128mm  
H305



**PULL**  
Tarvos Pull Handle Black  
Handle Centres - 160mm  
H308



**PULL**  
Rhea Pull Handle Black  
Handle Centres - 160mm  
H310



**KNOB**  
Delia Knob Brushed Brass  
Handle Centres - 0mm  
H311



**KNOB**  
Delia Knob Brushed Nickel  
Handle Centres - 0mm  
H312



**KNOB**  
Delia Knob Antique Copper  
Handle Centres - 0mm  
H313



**CUP**  
Delia Cup Handle Brushed Brass 139mm  
Handle Centres - 96mm  
H314



**CUP**  
Delia Handle Polished Nickel 139mm  
Handle Centres - 96mm  
H315



**CUP**  
Delia Handle Antique Copper 139mm  
Handle Centres - 96mm  
H316



**CUP**  
Jude Cup Handle Brushed Brass  
Handle Centres - 64mm  
H317



**CUP**  
Jude Handle Polished Nickel  
Handle Centres - 64mm  
H318



**CUP**  
Jude Handle Antique Copper  
Handle Centres - 64mm  
H319



**CURVE**  
Profile Handle Stainless Steel  
Available 45mm & 200mm  
Handle Centres - 32mm & 128mm  
H320 & H321



**CURVE**  
Profile Handle Black  
Available 45mm & 200mm  
Handle Centres - 32mm & 128mm  
H322 & H323



**CURVE**  
Noma Profile Stainless Steel  
Handle Centres - 256mm  
H325



**PULL**  
Pembroke D Handle Chrome  
Handle Centres - 192mm  
H327



**PULL**  
Pembroke D Polished Stainless Steel  
Handle Centres - 192mm  
H330



**BAR**  
Graf 2 Bar Black  
Handle Centres - 160mm  
H332



**BAR**  
Graf 2 Bar Dark Brass  
Handle Centres - 160mm  
H334



**PULL**  
U Pull Black  
Handle Centres - 128mm  
H336



**PULL**  
U Pull Polished Chrome  
Handle Centres - 128mm  
H339



**PULL**  
U Pull Brushed Brass  
Handle Centres - 128mm  
H342



**PULL**  
U Pull Brushed Copper  
Handle Centres - 128mm  
H345



**CUP**  
Rochdale Cup Satin Nickel  
Handle Centres - 96mm  
H348



**PULL**  
Rochdale Pull Satin Nickel  
Handle Centres - 128mm  
H349



**KNOB**  
Rochdale Knob Satin Nickel  
Handle Centres - 0mm  
H350



**KNOB**  
Oberon Knob Golden Champagne  
Handle Centres - 0mm  
H351



**KNOB**  
Oberon Knob Polished Nickel  
Handle Centres - 0mm  
H352



**CUP**  
Smooth Cup Cast Iron  
Handle Centres - 64mm  
H353



**BOW**  
Smooth Bow Cast Iron  
Handle Centres - 128mm  
H354



**KNOB**  
Smooth Knob Cast Iron  
Handle Centres - 0mm  
H355



**CUP**  
Mayberry Knob Polished Nickel  
Handle Centres - 96mm  
H356



**KNOB**  
Mayberry Knob Polished Nickel  
Handle Centres - 0mm  
H357



**BOW**  
Fabian Bow Pewter  
Handle Centres - 96mm  
H358



**BAR**  
Chelsea Bar Stainless Steel  
Handle Centres - 256mm  
H364



**BAR**  
Boston Bar Stainless Steel  
Handle Centres - 160mm  
H369



**BOW**  
Cordelia Bow Polished Chrome  
Handle Centres - 128mm  
H381



**PULL**  
Lincoln D Polished Chrome  
Handle Centres - 160mm  
H385



**PULL**  
Lincoln D Stainless Steel  
Handle Centres - 160mm  
H390



**BOW**  
Lewis Bow Stainless Steel  
Handle Centres - 160mm  
H395

# PURITY XPRESS RANGE CONTENT

ALL UNITS SHOWN IN PURITY XPRESS ARE FROM OUR SERIES | 2WO RANGE

Extra Tall Unit

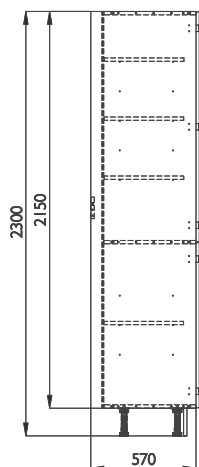

Tall Unit

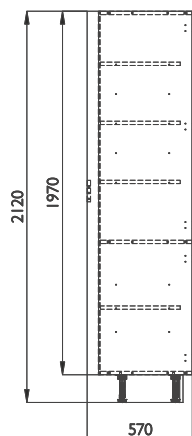

Wall Unit

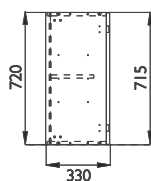

Bridging Units

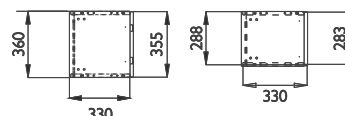

Base Unit

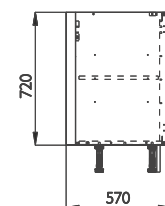

Boiler Unit

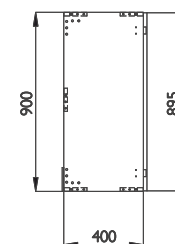

**Note:** Our larder, broom and appliance housing décor panels go all the way to the floor.

Corner Base Unit Planning 800W

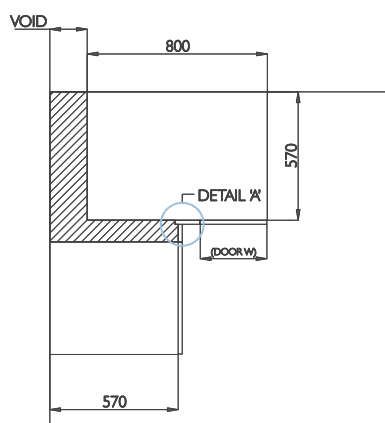

Corner Base Unit Planning 900W

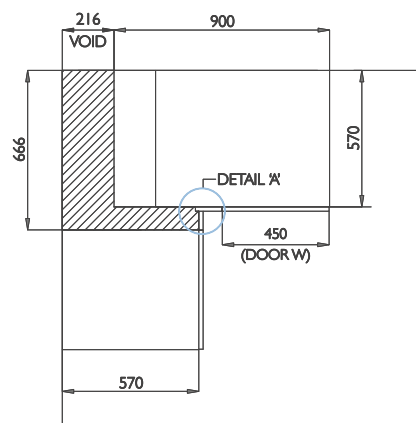

Detail A

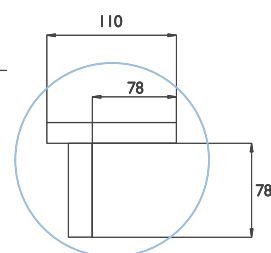

LH Shown, RH in Opposite Hand

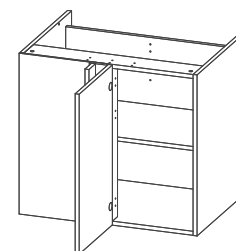

## Highline Units

0648 300W Door Void 166mm  
0649 400W Door Void 266mm  
0650 500W Door Void 366mm

## Highline Units

0403 445W Door Void 216mm  
0411 600W Door Void 366mm

## Drawerline Units

0658 400W Door Void 266mm

Corner Base Unit Planning 1200W

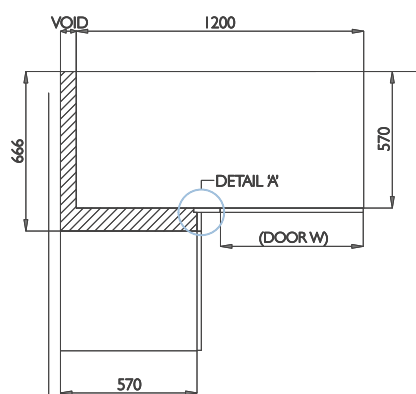

Corner Base Unit Planning 1000W

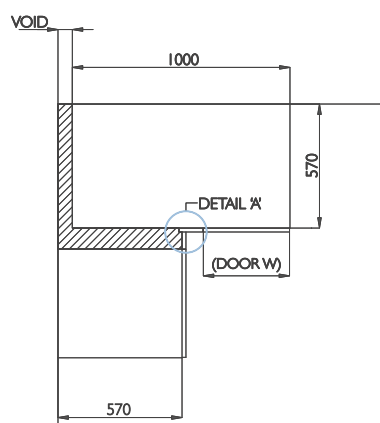

## Highline Corner Units

0651 400W Door Void 66mm  
0652 500W Door Void 166mm  
0653 600W Door Void 266mm

## Drawerline Corner Base

0661 500W Door Void 166mm  
0662 600W Door Void 266mm

## Drawerline Units

0404 600W Door Void 66mm  
0412 600W Door Void 66mm

Corner Wall Planning

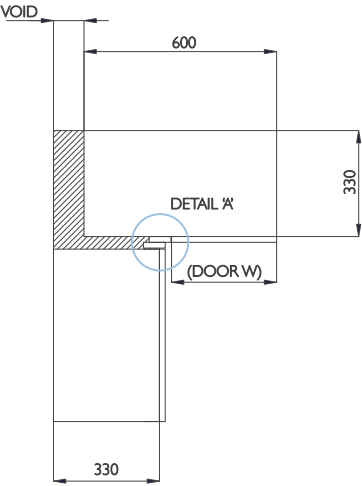

Detail A

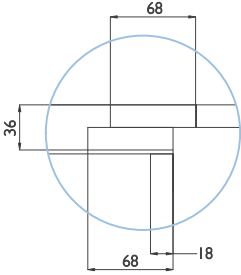

LH Shown,  
RH in opposite  
hand



720H Wall Units

0738 300W Door 66mm Void  
0504 400W Door 166mm Void

900H Wall Units

0756 300W Door 66mm Void  
0543 400W Door 166mm Void

2150mm Larders  
Pull Out / Swing Out

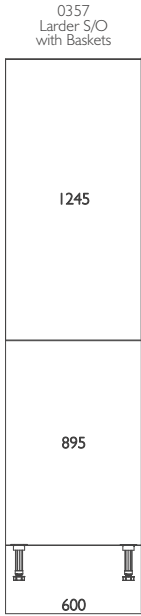

2150mm Larders /  
Appliance Housing

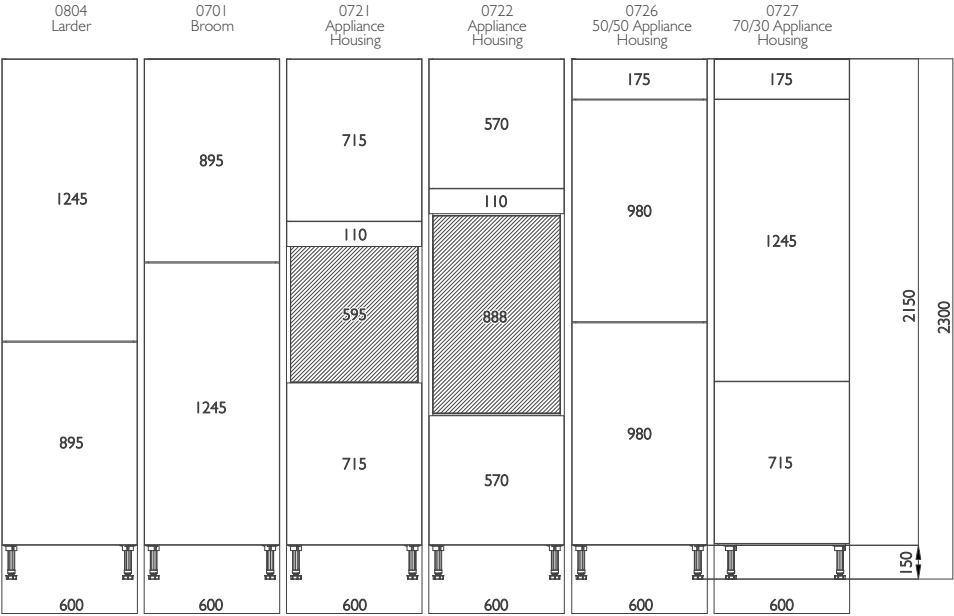

Pantry  
H 1970



Larders / Appliance Housing  
H 1970

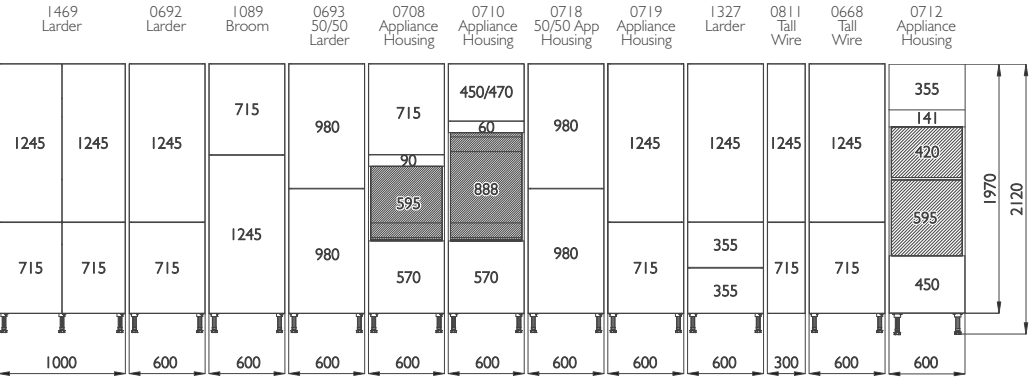

Base, Drawer & Wall Units  
H 1970 / 2150

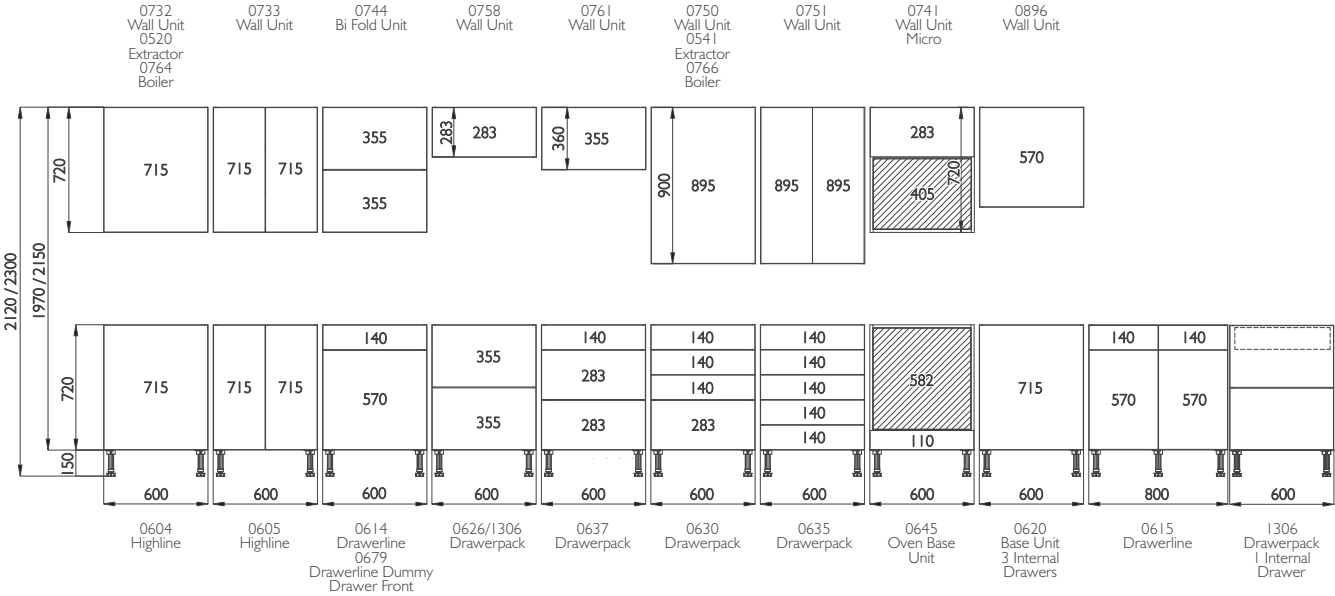

Highline Accessory Units

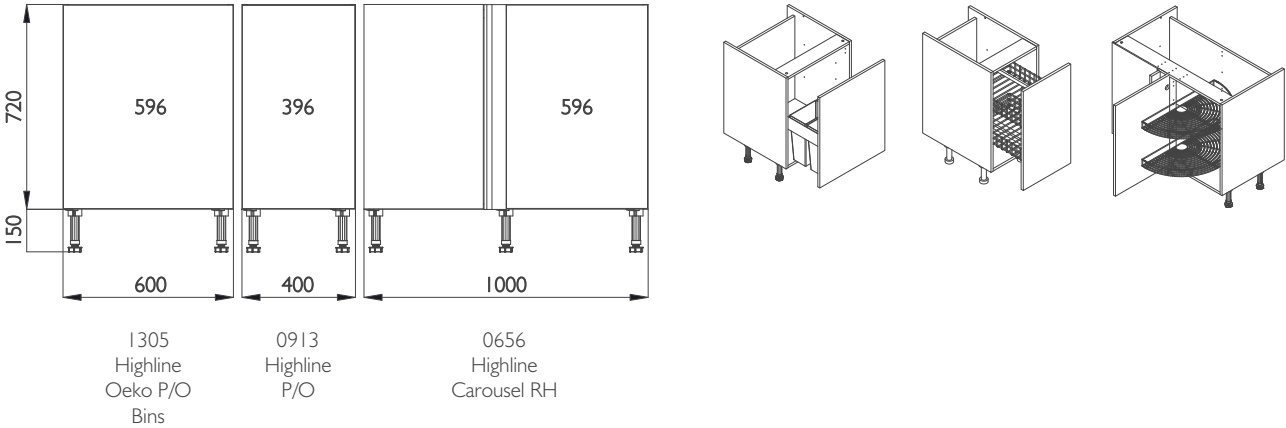

0679  
Drawerline with  
Dummy Drawer

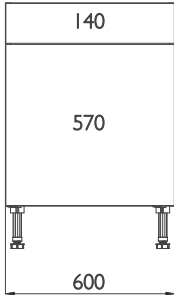

0680  
Drawerline with  
Dummy Drawer

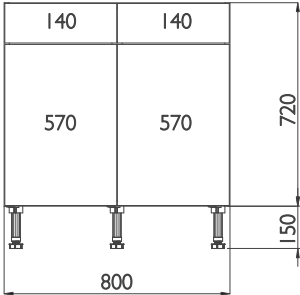

# PURITY VICINO RANGE CONTENT

Tall Unit

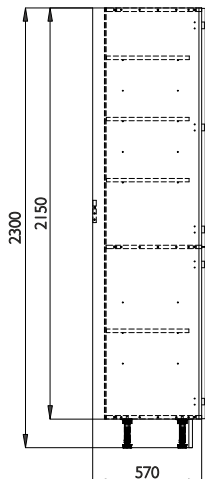

Medium Unit

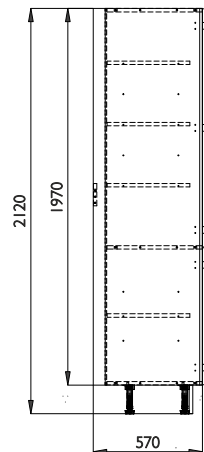

Low Unit

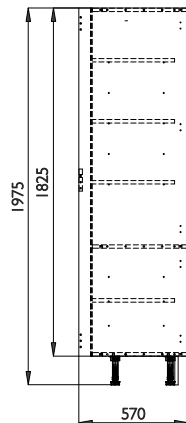

Studio Unit

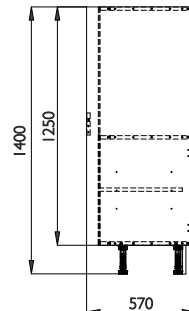

Wall Units

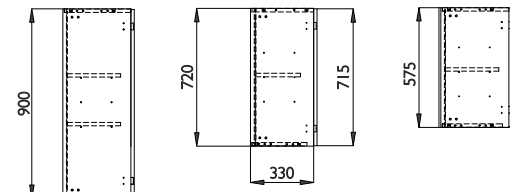

Bridging Units



Base Unit

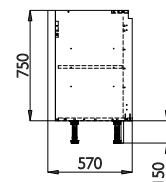

**Note:** Our larger, broom and appliance housing décor panels go all the way to the floor.

Corner Base Unit Planning 800W

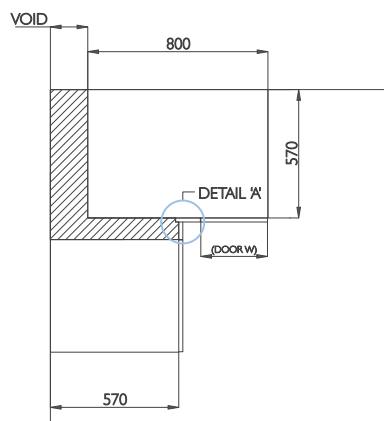

Corner Base Unit Planning 900W

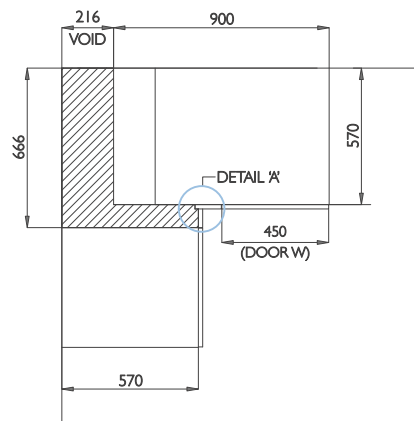

Detail A

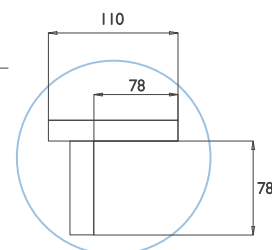

RH Unit, LH Blank

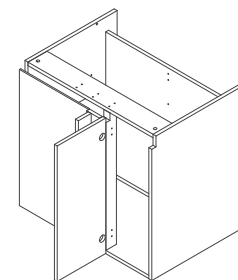

Highline Units

0648 300W Door Void 166mm  
0649 400W Door Void 266mm  
0650 500W Door Void 366mm

Highline Units

0403 445W Door Void 216mm

Corner Base Unit Planning 1000W

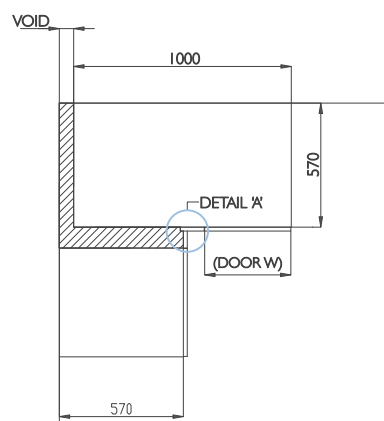

Corner Base Unit Planning 1200W

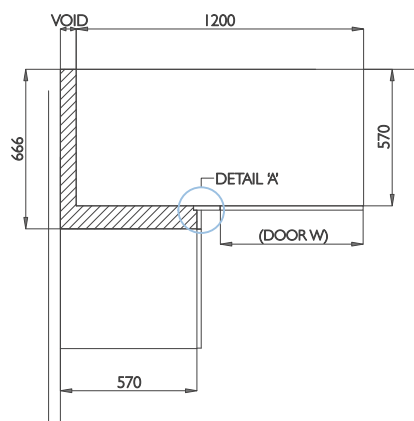

Highline Corner Units

0651 400W Door Void 66mm  
0652 500W Door Void 166mm  
0653 600W Door Void 266mm

Highline Corner Units

0404 600W Door Void 66mm

Highline Corner Base with Pull Out Carousel

0656 500W Door Void 166mm

Corner Wall Planning

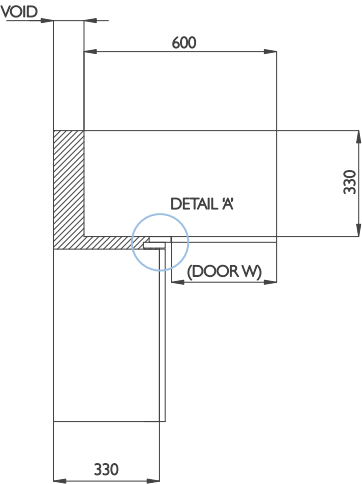

Detail A

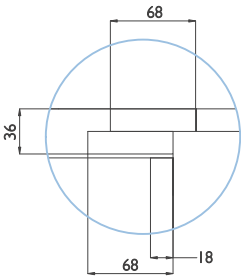

LH Shown,  
RH in opposite  
hand



**575H Wall Units**  
0899 300W Door 66mm Void  
0511 400W Door 166mm Void

**720H Wall Units**  
0738 300W Door 66mm Void  
0504 400W Door 166mm Void

**900H Wall Units**  
0756 300W Door 66mm Void  
0543 400W Door 166mm Void

Larders / Appliance Housing  
H 1970

Aperture is a guide. Always check manufacturer guide for fitting instructions. Fillers are supplies oversized for cutting onsite.

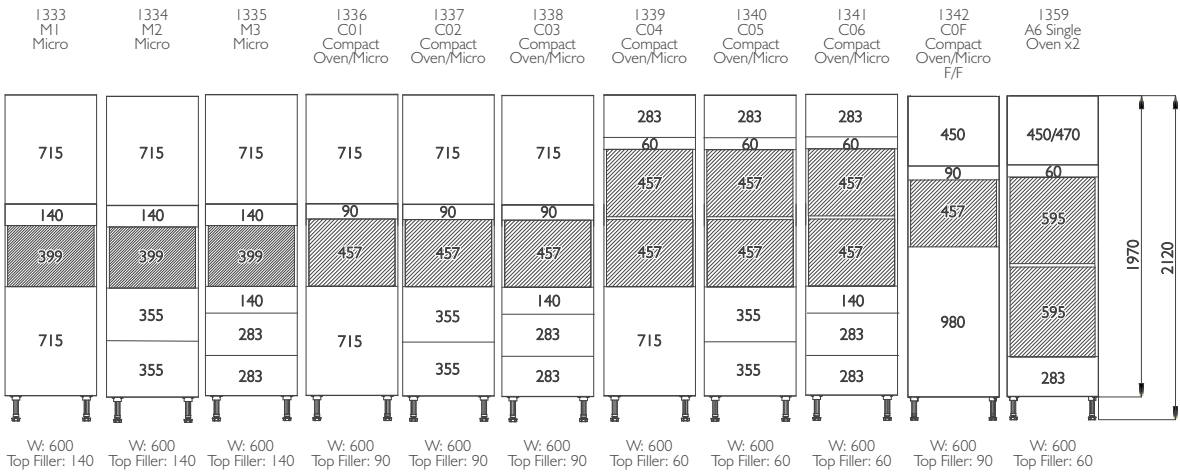
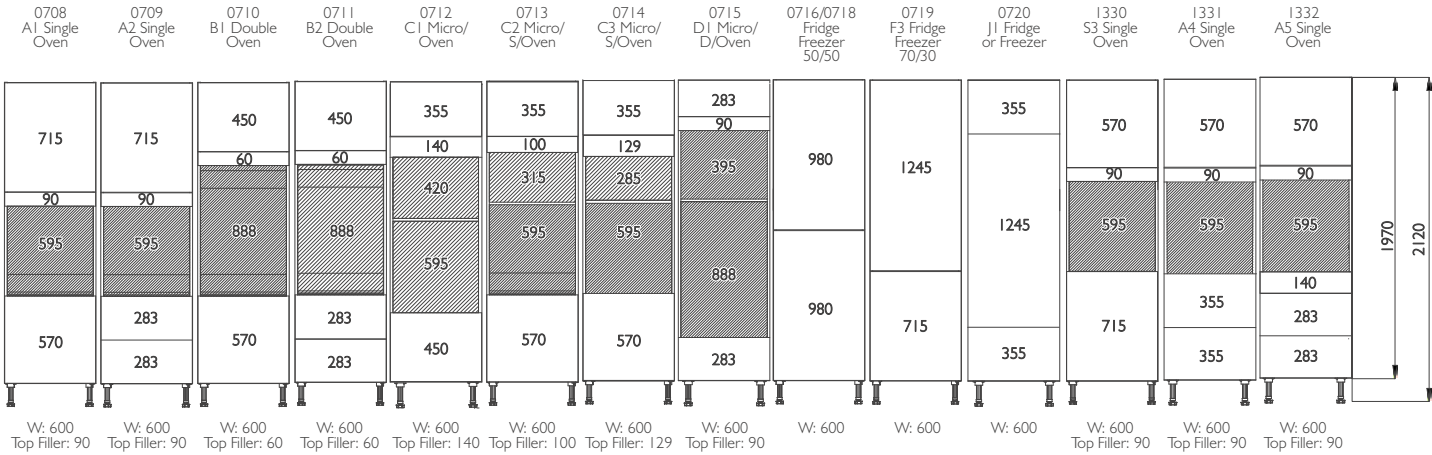

Larders / Appliance Housing  
H 2150

Aperture is a guide. Always check manufacturer guide for fitting instructions. Fillers are supplies oversized for cutting onsite.

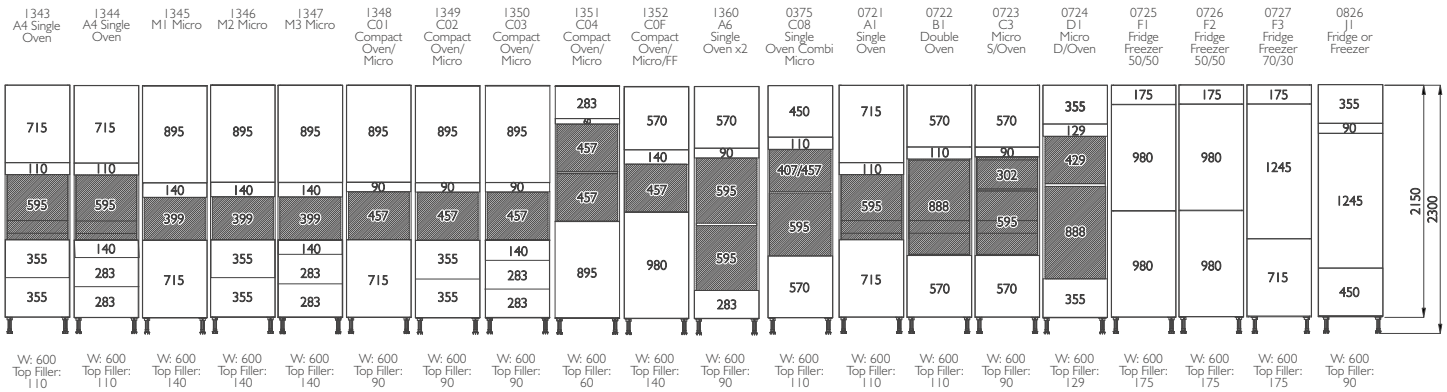

Base & Wall Units

Aperture is a guide. Always check manufacturer guide for fitting instructions.

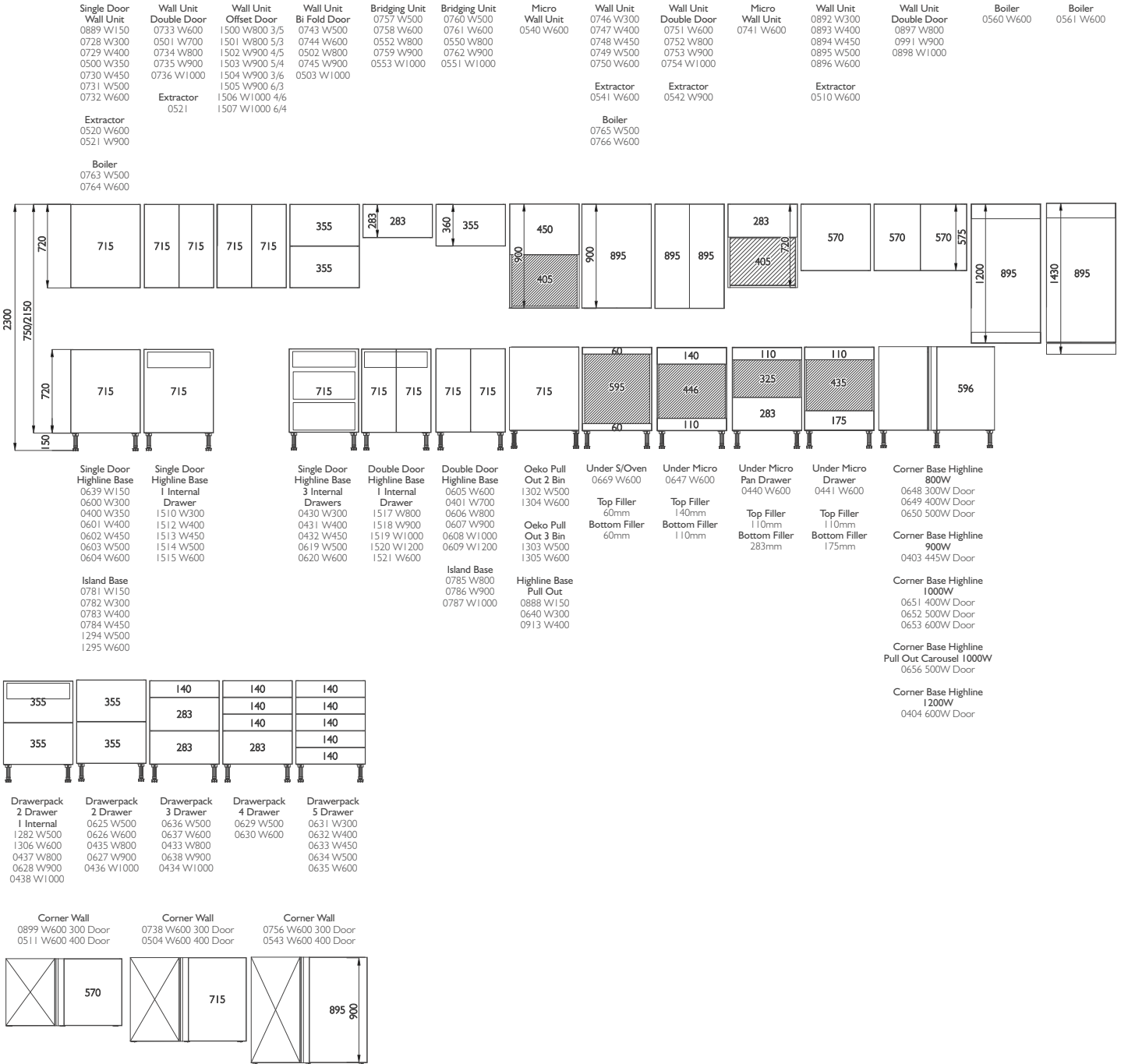

Larder / Broom  
330mm Deep

Fillers are supplies oversized for cutting onsite.

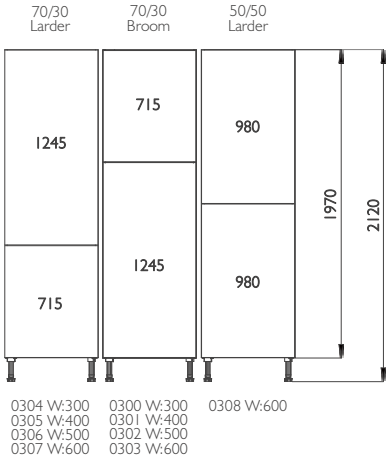
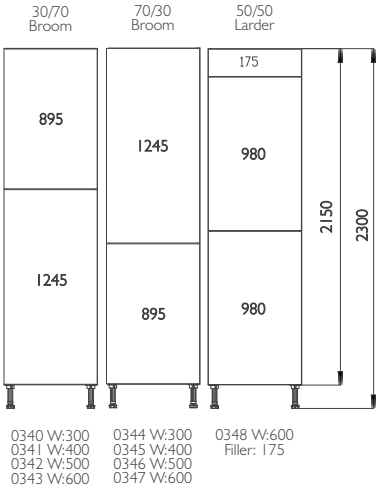

Larder / Broom / Appliance  
570mm Deep

Fillers are supplies oversized for cutting onsite.

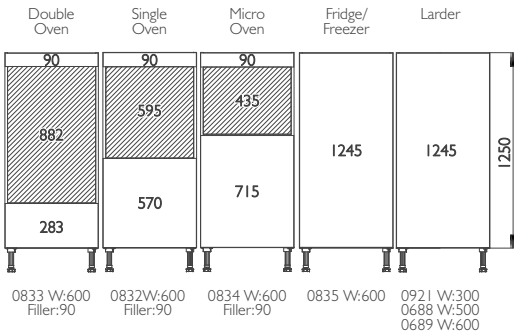
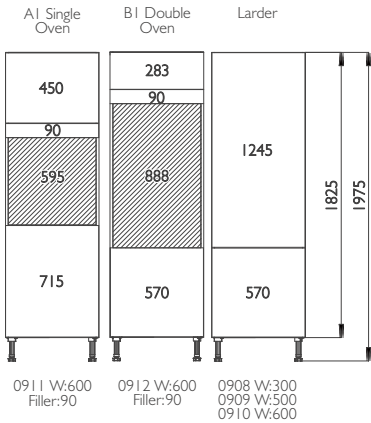
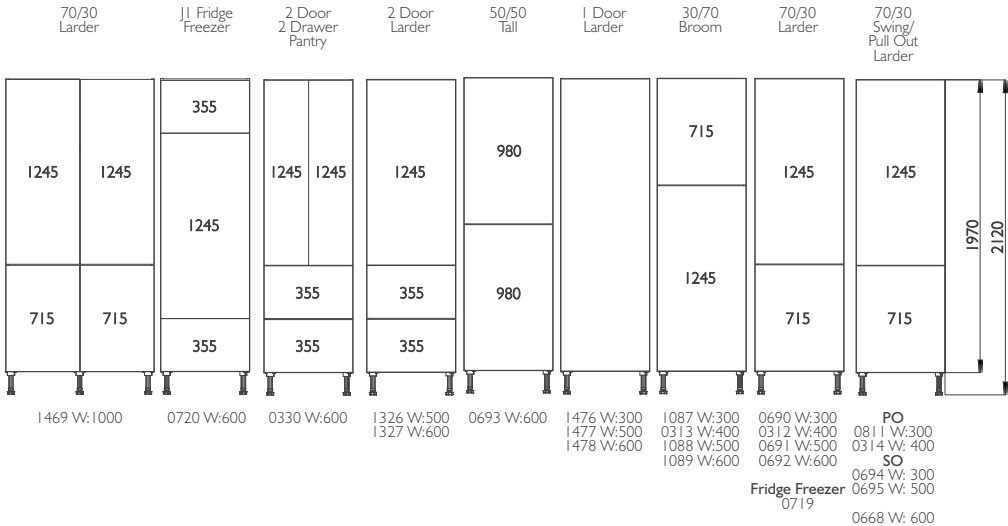
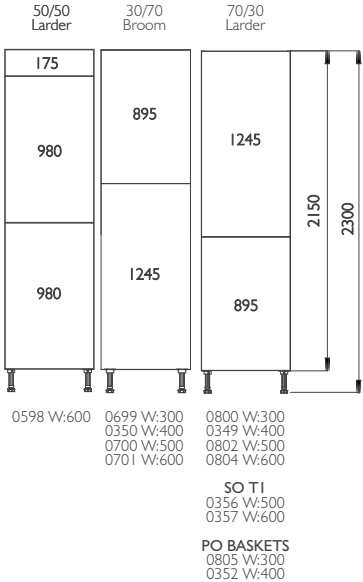

YOUR  
PURITY XPRESS  
DELIVERY DAY IS:

--



# PURITY

BY RICHMOND FURNITURE

## INTRODUCTION TO PURITY PORTFOLIO

# PURITY PORTFOLIO DOOR COLLECTION

Looking for your dream kitchen? Then look no further. A huge range of kitchens and accessories to suit every taste and budget.

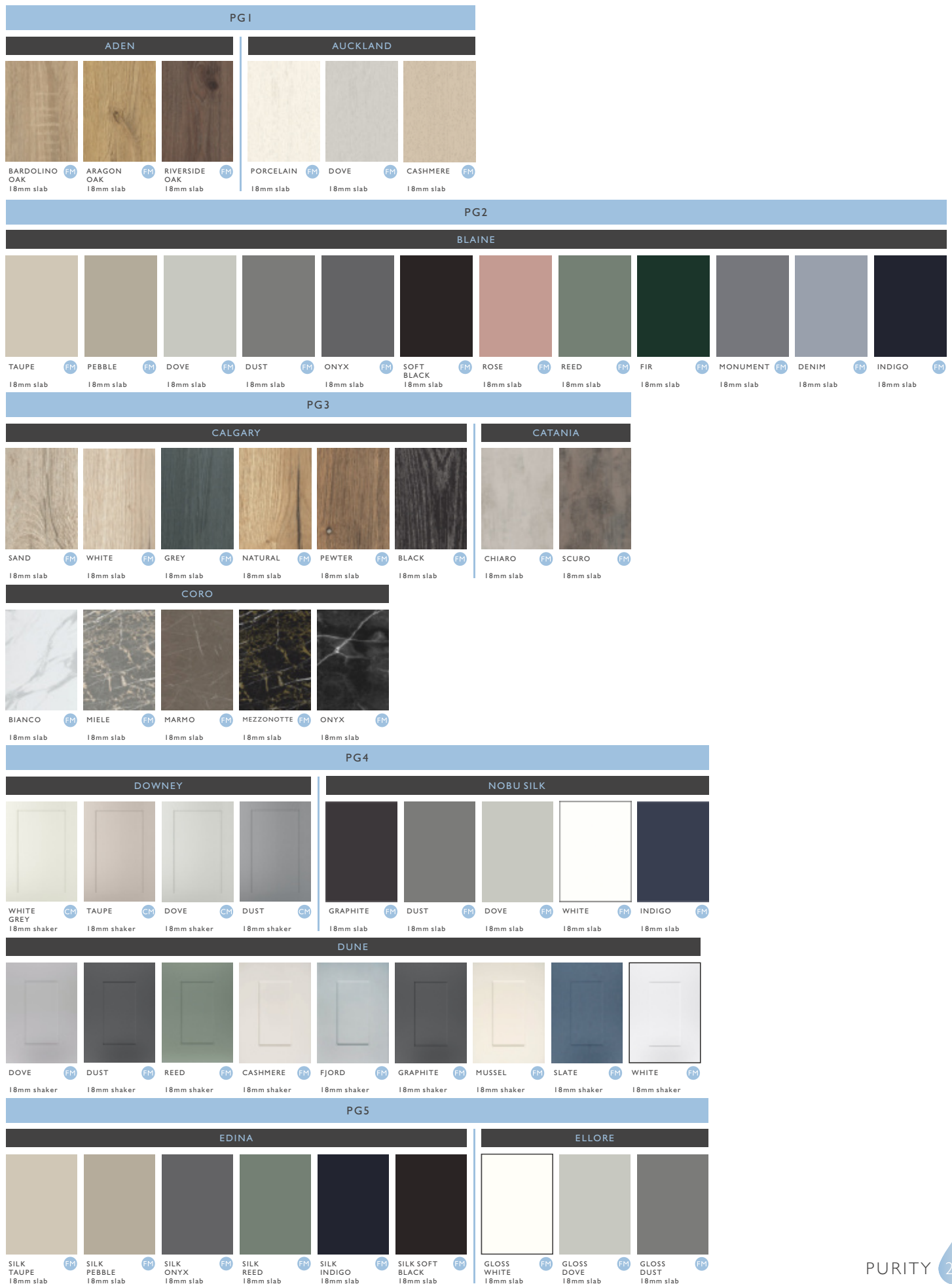

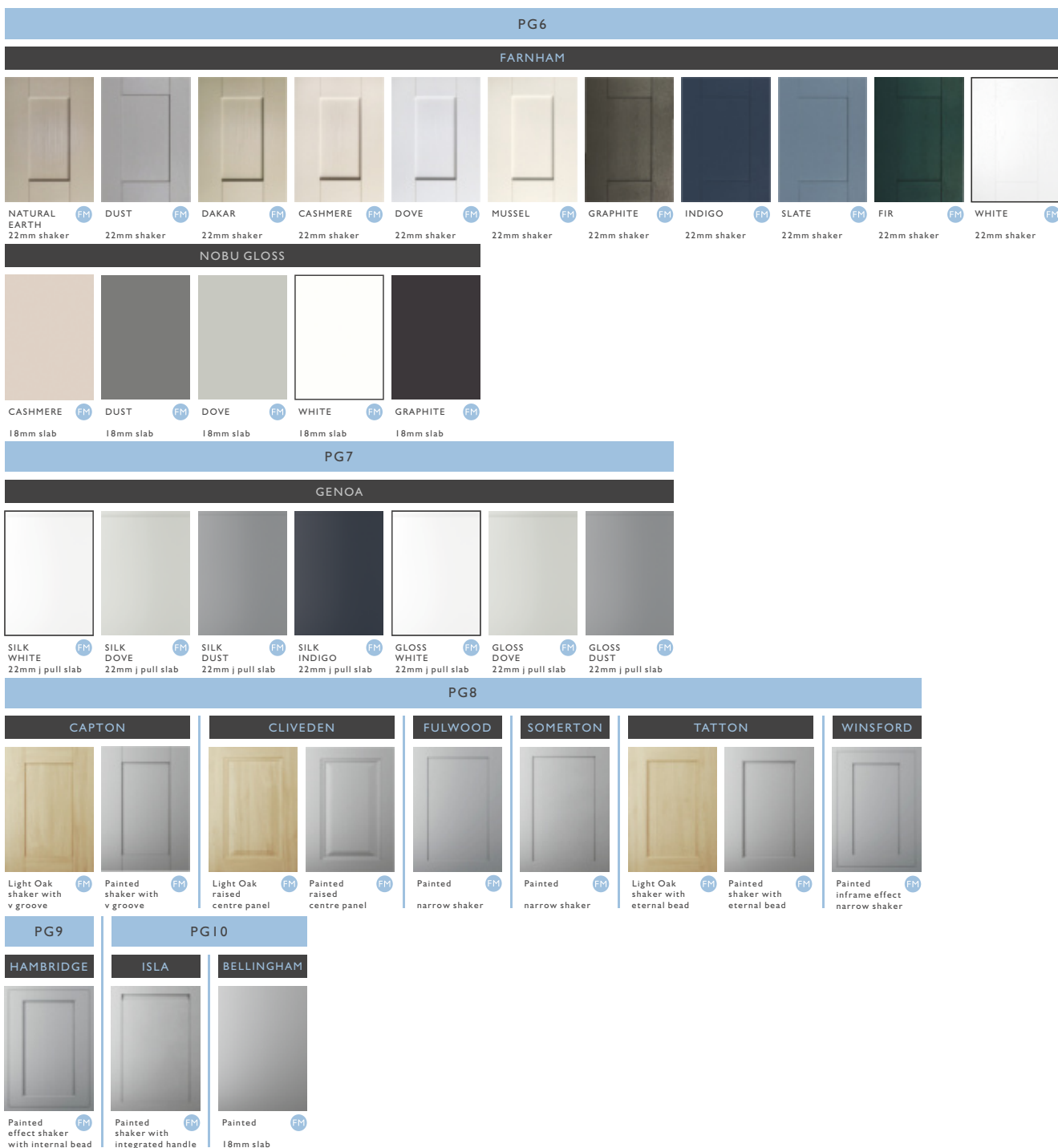

Your Purity Portfolio units comes in either SERIES | 3HREE in White, Oak or Onyx cabinets, or SERIES | 4OUR in White or Onyx as standard. Your visible cabinet ends are therefore White, Oak or Onyx. You can, of course, add our Frontal Matched or Colour Matched gable ends should you wish the visible ends of your cabinet to match the kitchen door. Alternatively, you can order our Frontal Matched or Colour Matched plant on panels. The guide below confirms which of our ranges are offered with Frontal Matched or Colour Matched gables and plant on panels.

FM

**FRONTAL MATCHED** When we use the term 'Frontal Matched' gables or plant on panels, this explains that the gables (sides of your units) or plant on panels (which attach to the visible sides of the units) will be manufactured from the same materials as the kitchen door, creating a 100% match. Your plinth and fillers will also be 'Frontal Matched'.

CM

**COLOUR MATCHED** When we use the term 'Colour Matched' gables or plant on panels, this explains that the gables (sides of your units) or plant on panels (which attach to the visible sides of the units) will NOT be manufactured from the same materials as the kitchen door, but in a substitute material. Usually, this will be a melamine-faced chipboard that matches the colour of the fascia, but not the finish of the door. Your plinth and fillers will also be 'Colour Matched'. **Always** consult Richmond for samples to approve.

# PURITY PORTFOLIO CABINET COLLECTION

## SERIES | 3HREE AS STANDARD

Our **SERIES | 3HREE** cabinet embodies true luxury, designed for the most sophisticated projects. Available in three stunning colours, it offers the flexibility to complement or contrast with your chosen kitchen style and palette. Featuring the Hettich integrated soft-close Premier Deluxe drawer system in Anthracite, this cabinet sets a new standard of elegance and functionality:

- ◆ Fully Rigid 18mm MFC Cabinet
- ◆ White, Onyx or Oak Interior Cabinet
- ◆ 570mm Deep Base Units
- ◆ 870mm High Base Units (Excludes Worktop)
- ◆ 18mm Solid Base Back Panel
- ◆ 8mm Solid Wall & Housing Back Panel
- ◆ 330mm Deep Wall Units
- ◆ Concealed Wall Hanging Bracket
- ◆ Premier Deluxe Hettich Atira Twin Wall, Soft Close Drawer Box in Anthracite
- ◆ Hettich 110o Clip On Hinge with Integrated Soft Close
- ◆ Service Gap 52mm on Base Units
- ◆ Service Gap 19mm on Wall Units
- ◆ Frontal Matched Corner Solution



CABINET  
COLOURS  
AVAILABLE

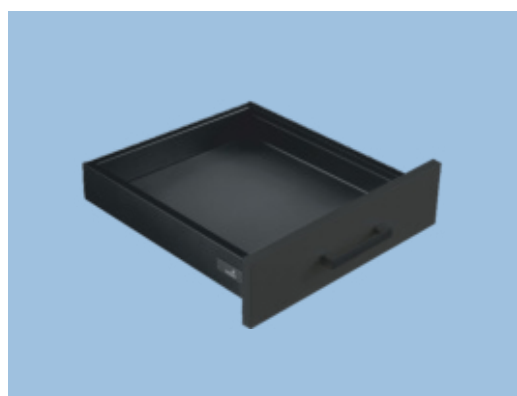
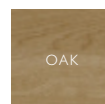

PREMIER  
DELUXE  
DRAWER  
SYSTEM  
AVAILABLE



## SERIES | 4OUR AS STANDARD

Our **SERIES | 4OUR** cabinet is crafted to deliver a seamless, true handleless kitchen experience. With its ultra-modern, urban-chic design, it's sure to make a lasting impression. Available in White or Onyx, each cabinet includes Hettich integrated soft-close doors and drawers as a standard feature:

- ◆ Fully Rigid 18mm MFC Cabinet (to suit handleless system)
- ◆ White or Onyx Interior Cabinet
- ◆ 570mm Deep Base Units
- ◆ 900mm High Base Units (Excludes Worktop)
- ◆ 18mm Solid Base Back Panel
- ◆ 8mm Solid Wall & Housing Back Panel
- ◆ 330mm Deep Wall Units
- ◆ Concealed Wall Hanging Bracket
- ◆ Premier Deluxe Hettich Atira Twin Wall, Soft Close Drawer Box in Anthracite
- ◆ Hettich 110o Clip On Hinge with Integrated Soft Close
- ◆ Service Gap 52mm on Base Units
- ◆ Service Gap 19mm on Wall Units
- ◆ Frontal Matched Corner Solution

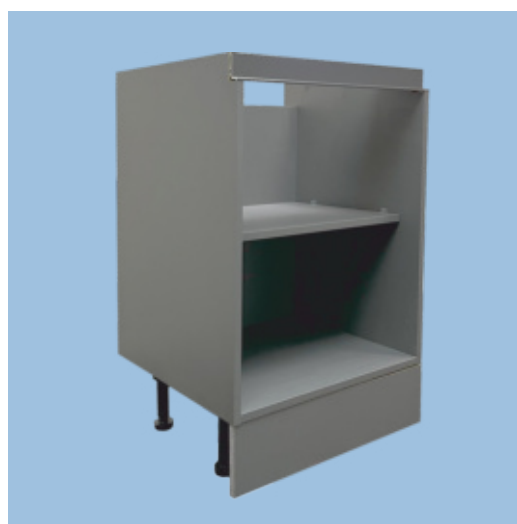

CABINET  
COLOURS  
AVAILABLE

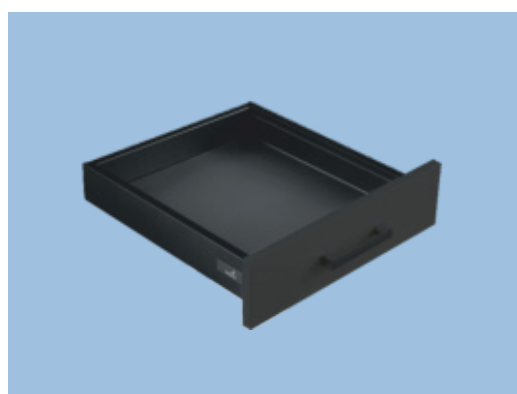

PREMIER  
DELUXE  
DRAWER  
SYSTEM  
AVAILABLE



# PURITY PORTFOLIO LAMINATE SURFACE COLLECTION

A collection of high pressure laminate surfaces engineered to the best of standards.

BANWELL  
CLOUD

BANWELL  
PEBBLE

BANWELL  
CARAMEL

BANWELL  
SLATE

BEAULY  
TREVISO

BEAULY  
GRIGIO

BEAULY  
CALCUTTA

BEAULY  
DONTTELLO

BRITT  
BLUSHWOOD

BRITT  
DRIFTWOOD

BRITT  
STORMWOOD

BRITT  
WARMWOOD

DEE  
SEAWOOD

DEE  
WASHWOOD

DEE  
WILDWOOD

DEE  
NATURALWOOD

DON  
LAURENT  
MARBLE

DON  
TUSCANY  
MARBLE

DON  
EMPERADOR  
MARBLE

DON  
PICASSO  
MARBLE

EMS  
LAURENT  
MARBLE

EMS  
TUSCANY  
MARBLE

EMS  
EMPERADOR  
MARBLE

EMS  
PICASSO  
MARBLE

## PG2 THE PREMIER DELUXE COLLECTION

Things just got a little bit more exciting with our recently launched blend of exotic stones, marbles and wood laminates. Surfaces are 40mm deep with a 3mm radius. Upstand 100mm high, square edge.

## PG4 THE 38MM SQUARE EDGED PREMIER PLUS COLLECTION

If you are looking for something a little more luxurious, then consider our 38mm Square Edged Premier Plus Collection. We offer a mix of exotic woods and marbles designed around the latest on-trend colour palettes. Let our 38mm square edge designs dramatise and inspire in your new kitchen space. All upstands are 100mm high with a 20mm post formed design.

## PG5 THE 22MM SQUARE EDGED PREMIER PLUS COLLECTION

Our 22mm slimline square edged selection create a wonderfully streamlined look. Choose our luxury marble designs to personalise your kitchen space. All upstands are 100mm high and 20mm deep.

# PURITY PORTFOLIO COMPACT LAMINATE SURFACE COLLECTION

Compact laminate surfaces provide any kitchen with a sleek and stylish finish, just 12.5mm in depth with square radius. Available in a range of stone and marble look textures, a compact laminate surface will add the finishing touch for breathtaking impact. Besides being beautifully contemporary, these surfaces are hardwearing and easy to maintain, perfect for well loved kitchens with years of use guaranteed.

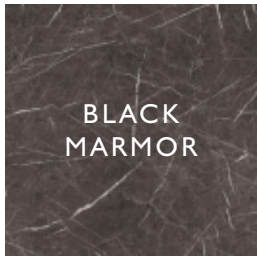

BLACK  
MARMOR

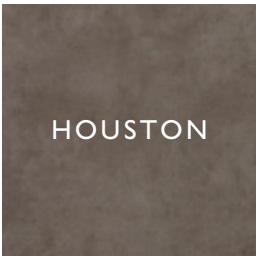

HOUSTON



MADISON



NEPTUNITE

PG1  
THE  
PREMIER  
COLLECTION

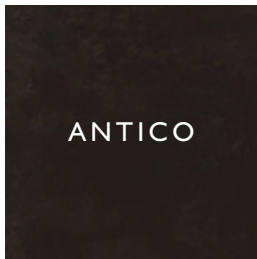

ANTICO

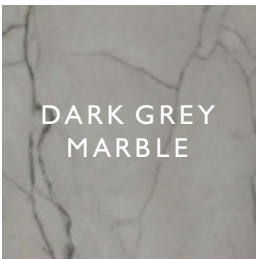

DARK GREY  
MARBLE

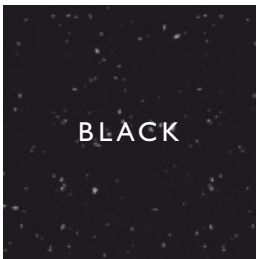

BLACK

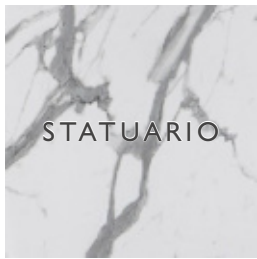

STATUARIO



VENICE  
MARBLE

PG2  
THE  
PREMIER PLUS  
COLLECTION



WHITE  
AURORA

PG3  
THE  
PREMIER DELUXE  
COLLECTION



# PURITY PORTFOLIO DEKLITE SURFACE COLLECTION

DEKLITE® by Cosentino is the first ultra-light surface which offers high resistance to impact, scratches, heat, chemicals and stains. Developed with 4mm Dekton® slabs and a unique, lightweight core, this surface is one of the most advanced at resisting impact and water penetration.

Besides being easy to cut and install, its non-porous surface ensures maximum hygiene; Deklite is really the surface that keeps giving. Whilst performing impeccably; these ranges are a stunning way to finish a kitchen.



AERIES



KRETA



SIRIUS

**PG1**  
THE  
PREMIER  
COLLECTION

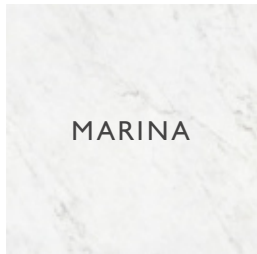

MARINA

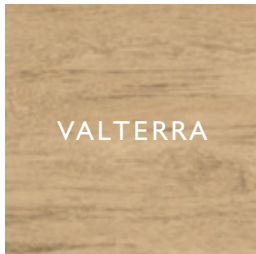

VALTERRA

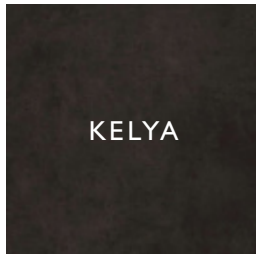

KELYA

**PG2**  
THE  
PREMIER PLUS  
COLLECTION



# PURITY PORTFOLIO SOLID ACRYLIC SURFACE COLLECTION

Welcome to minerva® the high quality and practical solid surface material. Manufactured using state of the art technology to deliver a luxurious appearance, which is cool to the touch but offers the most robust performance.

minerva® solid surfaces come with our 10 year guarantee and are supported by the FIRA Gold Award for product excellence. A surface that both looks and performs great. minerva® offers the flexibility to meet all your design needs without the cost nor requirement for specialist installation.



WHITE



ICE  
CRYSTAL



GREY  
CRYSTAL



ICE  
BLUE

THE  
PREMIER  
COLLECTION



PEAKSTONE



CARRARA  
WHITE



MARBLE  
WASH



GREY  
STORM



CHALK  
VENATO

THE  
PREMIER PLUS  
COLLECTION



BLUE  
VENATO



# PURITY PORTFOLIO SOLID QUARTZ SURFACE COLLECTION

Compac's Technological Quartz. A product of exceptional resistance and stunning beauty. The appearance and feel of natural quartz but with improved performance to withstand intensive use. These surfaces are resistant to impact, chemical and water so ideal for the kitchen. A fabulous collection of 8 colours, including 5 NEW introductions.



THE  
PREMIER  
COLLECTION



# PURITY PORTFOLIO SOLID QUARTZ SURFACE COLLECTION

Silestone®, the Ultimate Mineral HybriQ Surface. A surface of premium minerals, quartz, and recycled materials to dress interior spaces with colour and texture.

Silestone® is extremely durable in kitchens exposed to constant activity and use. In addition, it offers an exciting collection of colour and textures. For those who prefer to spend their valuable time on leisure, we have some good news: Silestone requires minimal maintenance and is highly resistant to stains and scratches.

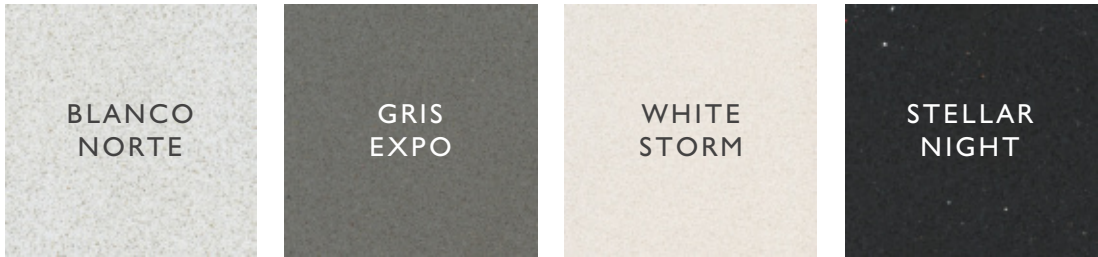

THE  
PREMIER PLUS  
COLLECTION



THE  
PREMIER DELUXE  
COLLECTION

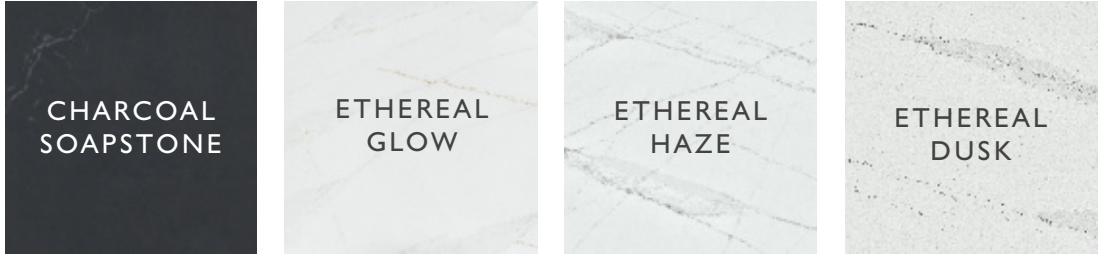

# PURITY PORTFOLIO DEKTON SURFACE COLLECTION

The surface for design and architecture. Dekton is a carbon neutral product. The ultra-compact porcelain surface is inspired by the beauty and aesthetics of natural stone. The unique manufacturing process allows Dekton to stretch beyond even nature; the platinum product performer.

With a variety of colours and sizes, Dekton inspires the future of architecture and design by creating soulful spaces where beauty and functionality coexist in perfect synergy. Innovation applied to design.

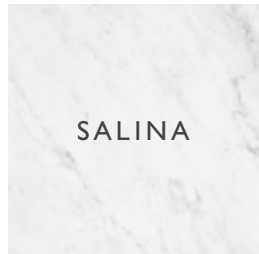

SALINA



MALIBU



TRILLIUM

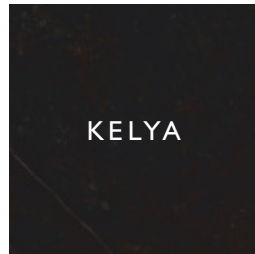

KELYA

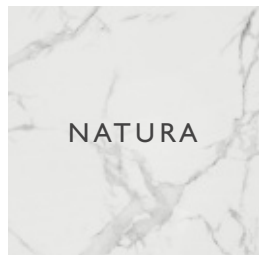

NATURA

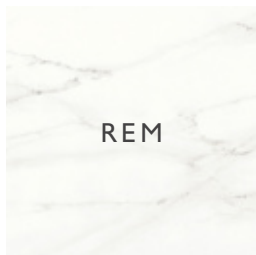

REM

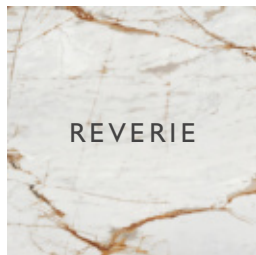

REVERIE

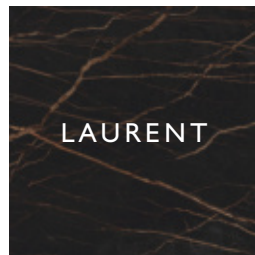

LAURENT

THE  
PREMIER PLUS  
COLLECTION



# PURITY PORTFOLIO HANDLE COLLECTION

The finishing touch; our design concepts take inspiration from many sources, from heritage artworks to natural vistas. Each handle in our range is unique and meticulously selected, with the material and finish chosen to expertly suit the design of the handle.



**T BAR**  
Bar Handle Brushed Nickel 185mm & 316mm  
Handle Centres - 128mm & 256mm  
H125 & H126



**BAR**  
Pimlico SS Bar Handle  
Handle Centres - 384mm & 192mm  
H175 & H176



**PULL**  
Pull Handle Chrome 136mm  
Handle Centres - 128mm  
H179



**CUP**  
Cup Handle Brushed Nickel  
Handle Centres - 76mm  
H285



**D**  
D Handle Copper  
Handle Centres - 160mm  
H286



**KNOB**  
Jude Knob Handle Brushed Brass  
Handle Centres - 0mm  
H287



**KNOB**  
Jude Knob Handle Polished Nickel  
Handle Centres - 0mm  
H288



**KNOB**  
Jude Knob Handle Antique Copper  
Handle Centres - 0mm  
H289



**TAPER**  
Taper Handle Satin 185mm  
Handle Centres - 128mm  
H301



**TAPER**  
Taper Handle Chrome 185mm  
Handle Centres - 128mm  
H302



**BOW**  
Bow Handle Brushed Nickel 180mm  
Handle Centres - 160mm  
H303



**KNOB**  
Knob Handle Polished Chrome 35mm  
Handle Centres - 0mm  
H304



**BOW**  
Bar Handle Polished Chrome 155mm  
Handle Centres - 128mm  
H305



**DIMPLE**  
Bow Handle Matt Nickel 156mm  
Handle Centres - 128mm  
H306



**PULL**  
Tarvos Pull Handle Black 136mm & 168mm  
Handle Centres - 128mm & 160mm  
H307 & H308



**PULL**  
Rhea Pull Handle Black 153mm & 185mm  
Handle Centres - 128mm & 160mm  
H309 & H310



**KNOB**  
Delia Knob Brushed Brass 35mm  
Handle Centres - 0mm  
H311



**KNOB**  
Delia Knob Brushed Nickel 35mm  
Handle Centres - 0mm  
H312



**KNOB**  
Delia Knob Antique Copper 35mm  
Handle Centres - 0mm  
H313



**CUP**  
Delia Cup Handle Brushed Brass 139mm  
Handle Centres - 96mm  
H314



**CUP**  
Delia Handle Polished Nickel 139mm  
Handle Centres - 96mm  
H315



**CUP**  
Delia Handle Antique Copper 139mm  
Handle Centres - 96mm  
H316



**CUP**  
Jude Cup Handle Brushed Copper 95mm  
Handle Centres - 64mm  
H317



**CUP**  
Jude Handle Polished Nickel 95mm  
Handle Centres - 64mm  
H318



**CUP**  
Jude Handle Antique Copper 95mm  
Handle Centres - 64mm  
H319



**CURVE**  
Profile Handle Stainless Steel 45mm & 200mm  
Handle Centres - 32mm & 128mm  
H320 & H321



**CURVE**  
Profile Handle Black 45mm & 200mm  
Handle Centres - 32mm & 128mm  
H322 & H323



**CURVE**  
Noma Profile Stainless Steel 200mm & 350mm  
Handle Centres - 128mm & 256mm  
H324 & H325



**PULL**  
Pembridge D Handle Chrome 136mm - 328mm  
Handle Centres - 128mm - 320mm  
H326 - H328



**PULL**  
Pembridge D Polished Stainless Steel 136mm - 328mm  
Handle Centres - 128mm - 320mm  
H329 - H331



**BAR**  
Graf 2 Bar Black 182mm & 278mm  
Handle Centres - 160mm & 256mm  
H332 & H333



**BAR**  
Graf 2 Bar Dark Brass 182mm & 278mm  
Handle Centres - 160mm & 256mm  
H334 & H335



**PULL**  
U Pull Black 136.5mm - 500.5mm  
Handle Centres - 128mm - 492mm  
H336 - H338



**PULL**  
U Pull Polished Chrome 136.5mm - 500.5mm  
Handle Centres - 128mm - 492mm  
H339 - H341



**PULL**  
U Pull Brushed Brass 136.5mm - 500.5mm  
Handle Centres - 128mm - 492mm  
H342 - H344



**PULL**  
U Pull Brushed Copper 136.5mm - 500.5mm  
Handle Centres - 128mm - 492mm  
H345 - H347



**CUP**  
Rochdale Cup Satin Nickel 135mm  
Handle Centres - 96mm  
H348



**PULL**  
Rochdale Pull Satin Nickel 154mm  
Handle Centres - 128mm  
H349



**KNOB**  
Rochdale Knob Satin Nickel 32mm  
Handle Centres - 0mm  
H350



**KNOB**  
Oberon Knob Golden Champagne 35mm  
Handle Centres - 0mm  
H351



**KNOB**  
Oberon Knob Polished Nickel 35mm  
Handle Centres - 0mm  
H352



**CUP**  
Smooth Cup Cast Iron 104mm  
Handle Centres - 64mm  
H353



**BOW**  
Smooth Bow Cast Iron 192mm  
Handle Centres - 128mm  
H354



**KNOB**  
Smooth Knob Cast Iron 35mm  
Handle Centres - 0mm  
H355



**CUP**  
Mayberry Knob Polished Nickel 128mm  
Handle Centres - 96mm  
H356



**KNOB**  
Mayberry Knob Polished Nickel 32mm  
Handle Centres - 0mm  
H357



**BOW**  
Fabian Bow Pewter 145.5mm  
Handle Centres - 96mm  
H358



**KNOB**  
Sorrento Knob Pewter 35mm  
Handle Centres - 0mm  
H359



**BAR**  
Bartram Bar Antique Copper 178mm & 220mm  
Handle Centres - 128mm & 160mm  
H360 & H361



**BAR**  
Chelsea Bar Stainless Steel 153mm - 702mm  
Handle Centres - 128mm - 632mm  
H362 - H367



**BAR**  
Boston Bar Stainless Steel 156mm - 509mm  
Handle Centres - 128mm - 481mm  
H368 - H378



**BOW**  
Melbury Bow Stainless Steel 172mm  
Handle Centres - 160mm  
H379



**BOW**  
Cordelia Bow Polished Chrome 86.5mm - 318mm  
Handle Centres - 68mm - 288mm  
H380 - H383



**PULL**  
Lincoln D Polished Chrome 113mm - 353mm  
Handle Centres - 96mm - 320mm  
H384 - H388



**PULL**  
Lincoln D Stainless Steel 113mm - 353mm  
Handle Centres - 96mm - 320mm  
H389 - H393



**BOW**  
Lewis Bow Stainless Steel 160mm & 193mm  
Handle Centres - 128mm & 160mm  
H394 & H395



**KNOB**  
Ariel Knob Handle Pewter 33mm  
Handle Centres - 0mm  
H398



**CUP**  
Ariel Cup Handle Pewter  
Handle Centres - 76mm  
H399



**KNOB**  
Henrietta Knob Handle Brushed Nickel 38mm  
Handle Centres - 0mm  
H400

# PURITY PORTFOLIO RANGE CONTENT

**S3** DENOTES OUR **SERIES | 3** HREE UNIT SIZES

**S4** DENOTES OUR **SERIES | 4** OUR UNIT SIZES

Tall Unit **S3 S4**

Standard Unit **S3 S4**

Low Height Unit **S3**

Studio Unit **S3**

Bridging Units **S3 S4**

Wall Unit **S3 S4**

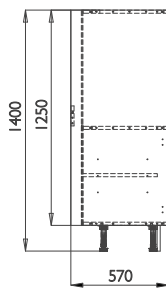
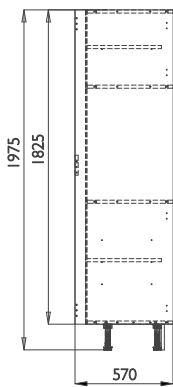
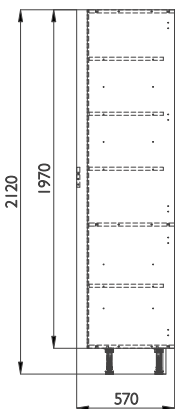
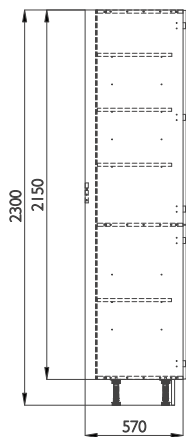

Note: Our complimentary larder / broom and appliance housing decor panels go all the way to the floor and are oversized by 173mm to allow them to be scribed as required.

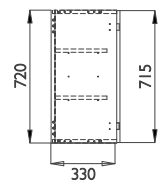
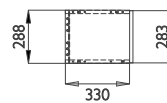
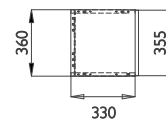

Base Unit **S3**

Base Unit **S4**

Base Unit **S3 S4**

Base Unit **S4**

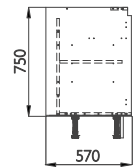
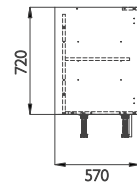
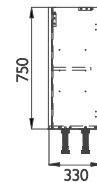
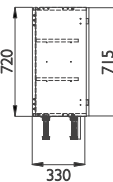

Corner Base Unit Planning 800W

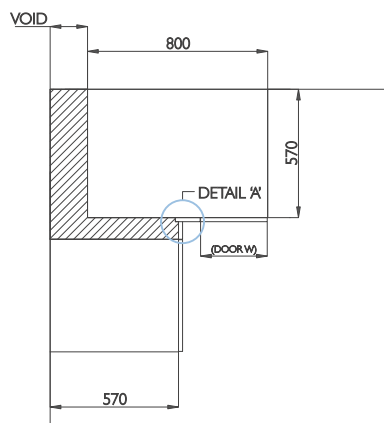

Corner Base Unit Planning 900W

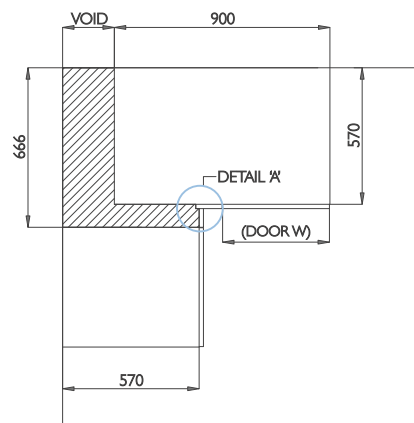

Detail A

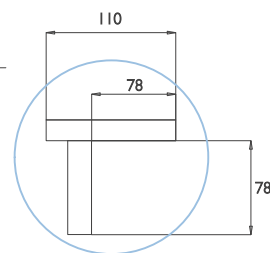

LH Shown, RH in Opposite Hand

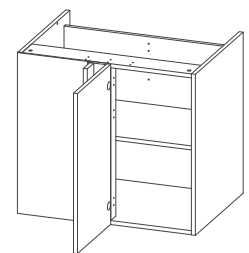

Highline Units **S3 S4**

0648 300W Door Void 166mm  
0649 400W Door Void 266mm  
0650 500W Door Void 366mm

Highline Units **S3 S4**

0403 445W Door Void 216mm  
0411 600W Door Void 366mm

Drawerline Units **S3**

0657 300W Door Void 166mm  
0658 400W Door Void 266mm  
0659 500W Door Void 366mm

Corner Base Unit Planning 1200W

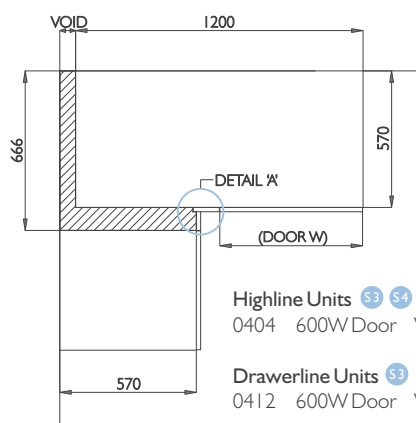

Highline Units **S3 S4**

0404 600W Door Void 66mm

Drawerline Units **S3**

0412 600W Door Void 66mm

Highline / Drawerline / Carousel  
Corner Base 1000W

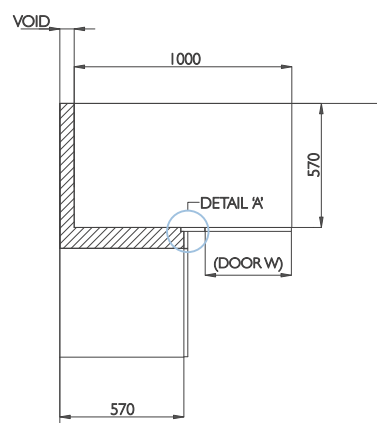

Highline Corner Units **S3 S4**

0651 400W Door Void 66mm  
0652 500W Door Void 166mm  
0653 600W Door Void 266mm

Highline Corner Base with 1/2 Carousel **S3 S4**

0655 500W Door Void 166mm

Highline Corner Base with Pull Out Carousel **S3 S4**

0656 500W Door Void 166mm

Drawerline Corner Base **S3**

0660 400W Door Void 66mm  
0661 500W Door Void 166mm  
0662 600W Door Void 266mm

Drawerline Corner Base with Pull Out Carousel **S3**

0664 500W Door Void 166mm  
0665 500W Door Void 166mm

## Angled Corner Wall Planning S3

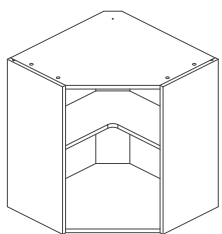
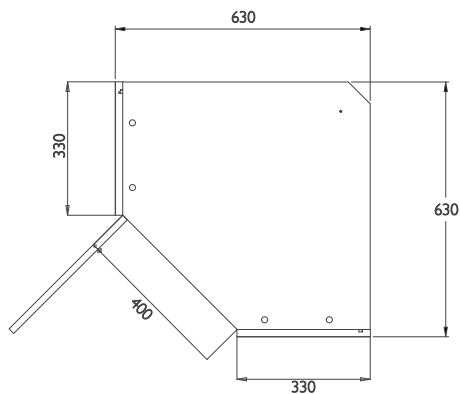

1450 630W Corner Wall  
400W Door

## L Shape Corner Wall Unit S3 S4

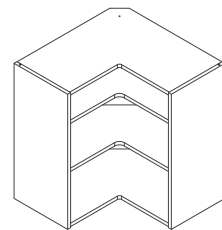
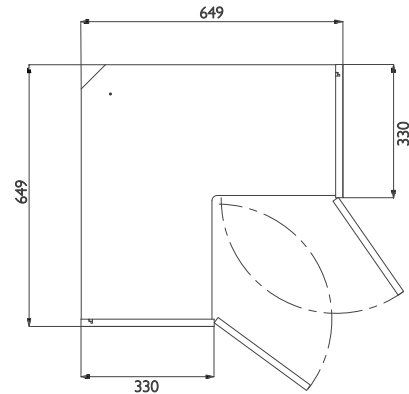

0739 650W Corner Wall  
715x296mm Door

## L Shape Corner Base Unit S3

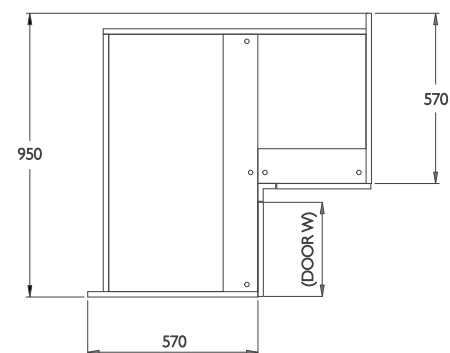

0666 L Shape Corner Base  
0667 950W L Shape Corner Base with Carousel

## L Shape Highline Corner S4

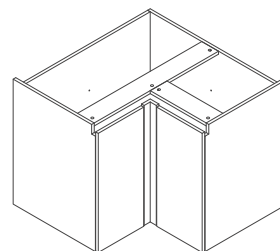
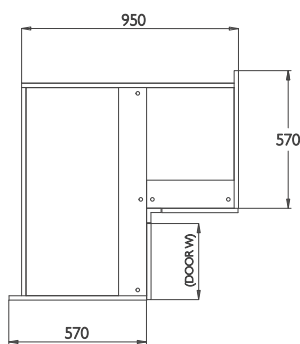

0666/0667 L Shape Highline Corner 3/4 Carousel 950W

## 1000W Corner Planning S3

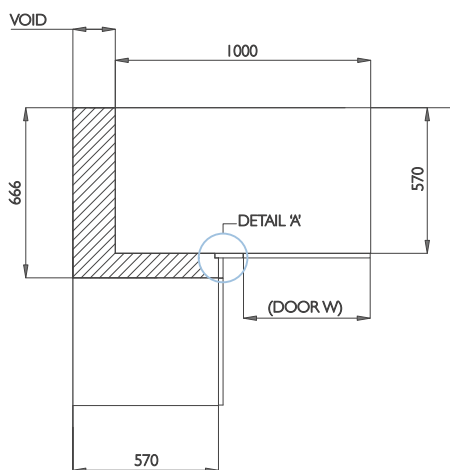

### Detail A

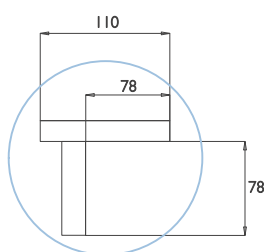

### LH Shown, RH in opposite hand

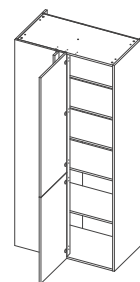

### 1970H

0641	500W Door	166mm Void
0642	600W Door	266mm Void
0322	600W Door	266mm Void
0324	500W Door	166mm Void
0325	600W Door	266mm Void

### 2150H

0358	500W Door	166mm Void
0359	600W Door	266mm Void
0362	600W Door	266mm Void

## Corner Walk in Larder Units S3

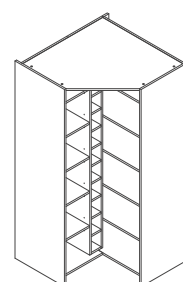
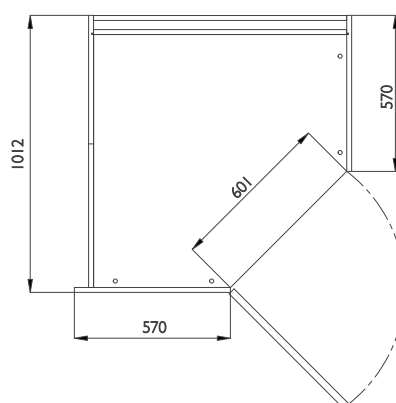
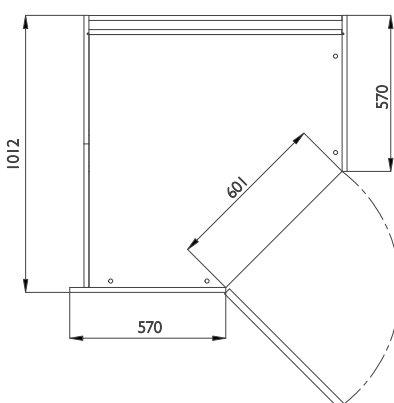

0328 1000W Full Height Door  
1083 1000W

### Detail A

LH Shown,  
RH in opposite  
hand

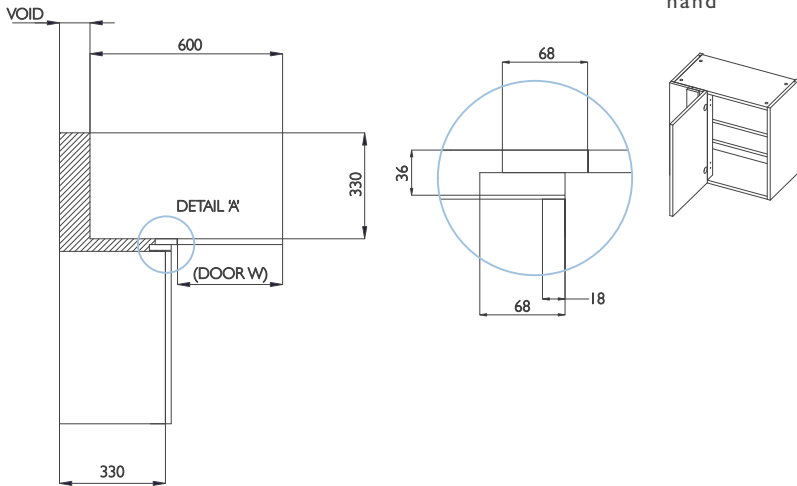

## Corner Wall Planning

0899	300W Door	66mm Void
0511	400W Door	166mm Void

## 720H Wall Units

0738	300W Door	66mm Void
0504	400W Door	166mm Void

## 900H Wall Units

0756	300W Door	66mm Void
0543	400W Door	166mm Void

Larder / Broom 330mm Deep\* S3 S4

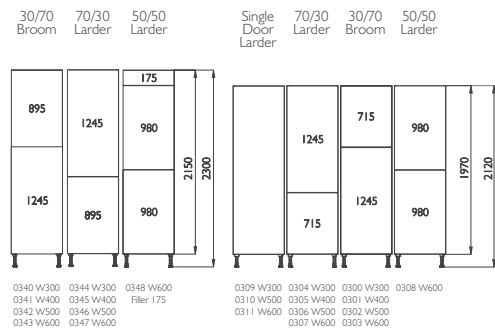

Larder / Broom / Appliance 570mm Deep\*

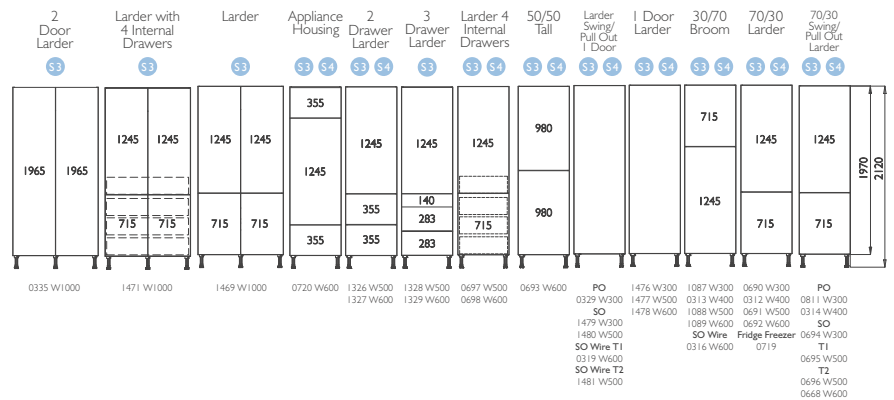

Larder / Broom 570mm Deep\*

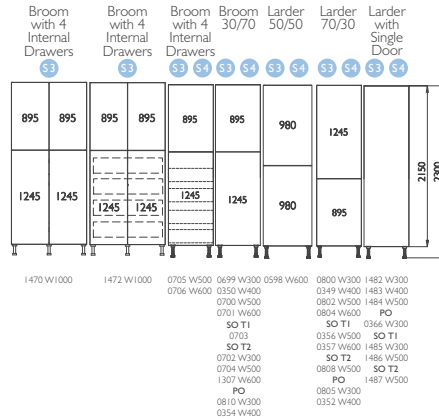

Larder / Appliance 570mm Deep\* S3 S4

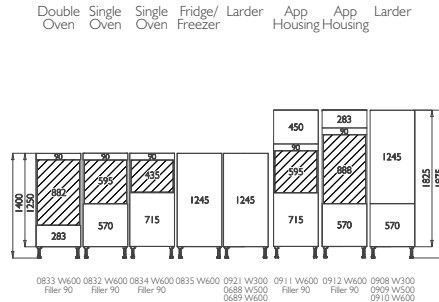

Corner Larder 570mm Deep\* S3 S4

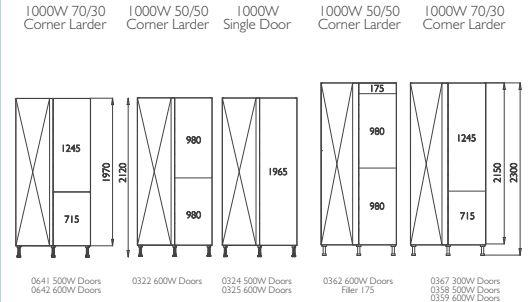

## 1970 Appliance Housing\* S3 S4

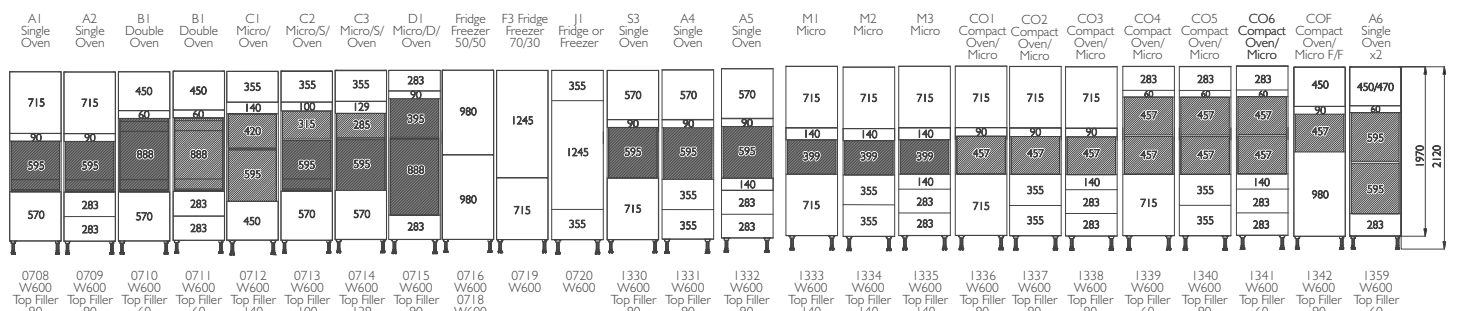

\*Aperture is a guide. Always check manufacturer guide for fitting instructions. Fillers are supplied oversized for cutting onsite.

## 2150 Appliance Housing S3 S4

A4 Single Oven	A5 Single Oven	M1 Micro	M2 Micro	M3 Micro	CO1 Compact Oven/ Micro	CO2 Compact Oven/ Micro	CO3 Compact Oven/ Micro	CO4 Compact Oven/ Micro	COF Compact Oven/ Micro FF	A6 Single Oven x2	CO8 Single Oven Combi Micro	A1 Single Oven	B1 Double Oven	C3 Micro S/Oven	D1 Micro D/Oven	F1 Fridge Freezer 50/50	F2 Fridge Freezer	F3 Fridge Freezer 70/30	J1 Fridge or Freezer
715	715	895	895	895	895	895	895	283 457 457	570	570	450 110 407/457	715	570	570	355 129 429	175	175	175	355 90 1245
110	110	140	140	140	90	90	90	457	140	90	595	110	110	90	429	980	980	1245	90
595	595	399	399	399	457	457	457	457	457	595	595	595	888	595	888	980	980	715	1245
355	140	715	355	140	715	355	140	895	980	595	570	715	570	570	355	980	980	715	450
355	283	355	355	283	355	355	283	283	283	283	283	283	283	283	283	283	283	283	283
1343 W600 Top Filler 110	1344 W600 Top Filler 110	1345 W600 Top Filler 140	1346 W600 Top Filler 140	1347 W600 Top Filler 140	1348 W600 Top Filler 90	1349 W600 Top Filler 90	1350 W600 Top Filler 90	1351 W600 Top Filler 60	1352 W600 Top Filler 140	1360 W600 Top Filler 90	0375 W600 Top Filler 110	0721 W600 Top Filler 110	0722 W600 Top Filler 110	0723 W600 Top Filler 90	0724 W600 Top Filler 129	0725 W600 Top Filler 175	0726 W600 Top Filler 175	0727 W600 Top Filler 175	0826 W600 Top Filler 90

Aperture is a guide. Always check manufacturer guide for fitting instructions. Fillers are supplied oversized for cutting onsite.

### Curved Base Units S3

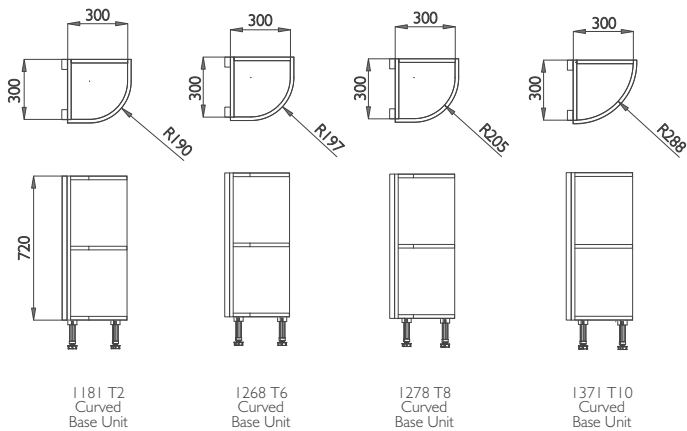

### Curved Wall Units S3

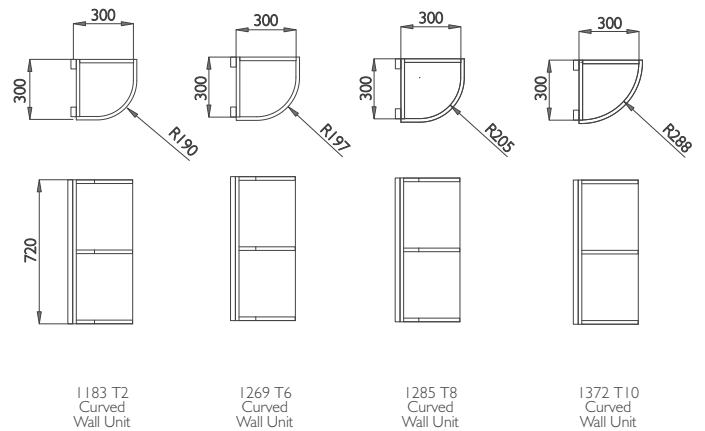

### Boiler Housing S3 S4

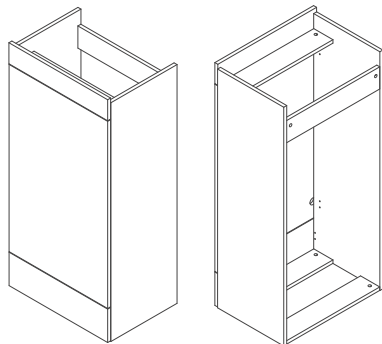

- 0560 - 1250H Recommended to be used in conjunction with 720H wall units and 1970H tall units.
- 0561 - 1430H Recommended to be used in conjunction with 900H wall units and 2150H tall units.

Housing designed to be height adjustable based on the thickness of the worktop, end panel and top filler cut to size to line through with the top of the wall/tall units. fitter trims during installation.

This unit is supplied with no top or bottom panel, the rear stays are for transport purposes and should be removed as necessary. Please always consult with the appliance manufacturer before using this unit as to its suitability.

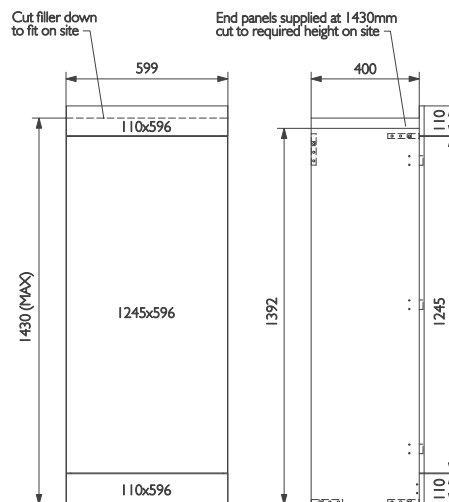
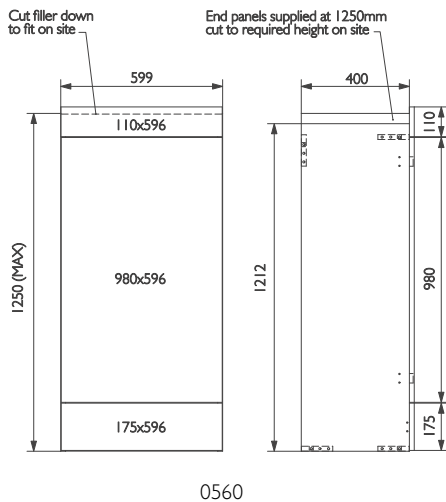

0561

Single Door Wall Unit 0889 W150 0728 W300 0729 W400 0500 W350 0729 W350 0730 W450 0731 W500 0732 W600	Wall Unit Glazed Door 0926 W500	Wall Unit Double Door 0733 W600 0501 W700 0734 W800 0735 W900 0736 W1000	Wall Unit Bi Fold Door 0743 W500 0744 W600 0502 W800 0745 W900 0503 W1000	Bridging Unit 0757 W500 0758 W600 0552 W800 0759 W900 0553 W1000	Bridging Unit 0760 W500 0761 W600 0550 W800 0762 W900 0551 W1000	Micro Wall Unit 0540 W600	Wall Unit 0746 W300 0747 W400 0748 W450 0749 W500 0750 W600	Wall Unit Double Door 0751 W600 0752 W800 0753 W900 0754 W1000	Micro Wall Unit 0741 W600	Wall Unit 0892 W300 0893 W400 0894 W450 0895 W500 0896 W600	Wall Unit Double Door 0897 W800 0991 W900 0898 W1000	Boiler 0560 W600	Boiler 0561 W600
Extractor 0520 W600		Extractor 0521		Wall Unit 0308 W500 0309 W600	Wall Unit 1311 W500 1312 W600		Extractor 0541 W600	Extractor 0542 W900		Extractor 0510 W600			
Boiler 0763 W500 0764 W600							Boiler 0765 W500 0766 W600						

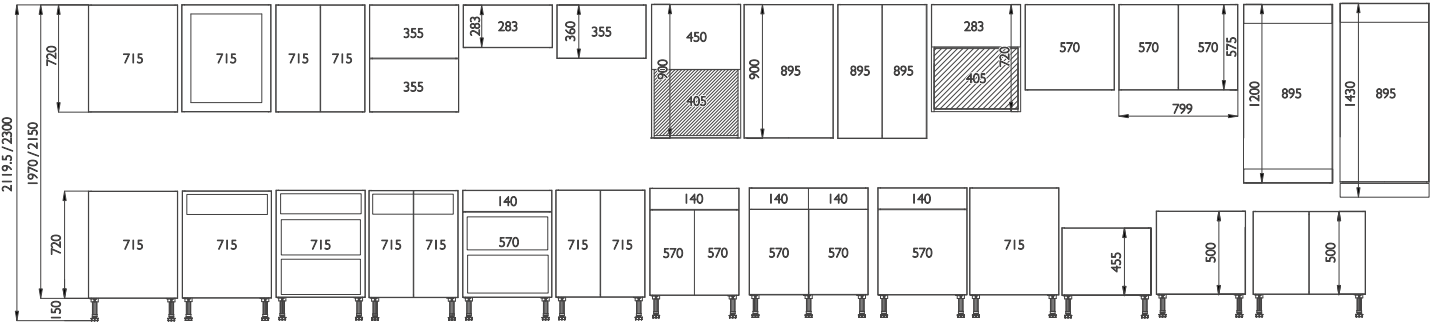

Single Door Highline Base 0639 W150 0600 W300 0400 W350 0601 W400 0602 W450 0603 W500 0604 W600	Single Door Highline Base 1 Internal Drawer 1510 W300 1512 W400 1513 W450 1514 W500 1515 W600	Single Door Highline Base 3 Internal Drawers 0430 W300 0431 W400 0432 W450 0619 W500 0620 W600	Double Door Highline Base 1 Internal Drawer 1517 W800 1518 W900 1519 W1000 1520 W1200 1521 W600	Single Door Drawerline Base 2 Internal Drawers* 0621 W500 0622 W600	Double Door Highline Base 0605 W600 0401 W700 0606 W800 0607 W900 0608 W1000 0609 W1200	Double Door Drawerline Base* 0676 W600 0677 W900	Double Door Drawerline Base* 0615 W800 0616 W900 0617 W1000 0410 W1200	Single Door Drawerline Base* 0610 W300 0611 W400 0612 W450 0613 W500 0614 W600	Oeko Pull Our 2 Bin 1302 W500 1304 W600	Belfast Sink* 0927 W600	Belfast Sink* 0424 W600	Belfast Sink* 0425 W800
Island Base 0781 W150 0782 W300 0783 W400 0784 W450 1294 W500 1295 W600					Island Base 0785 W800 0786 W900 0787 W1000		2 Dummy Drawers* 0680 W800 0681 W900 0682 W1000 0423 W1200	Single Door Dummy Drawer* 0679 W600	Oeko Pull Out 3 Bin 1303 W500 1305 W600			
							1 Dummy Drawer* 0420 W800 0421 W900 0684 W1000 0422 W1200		Range Fascia 0888 W150 0640 W300 0913 W400			

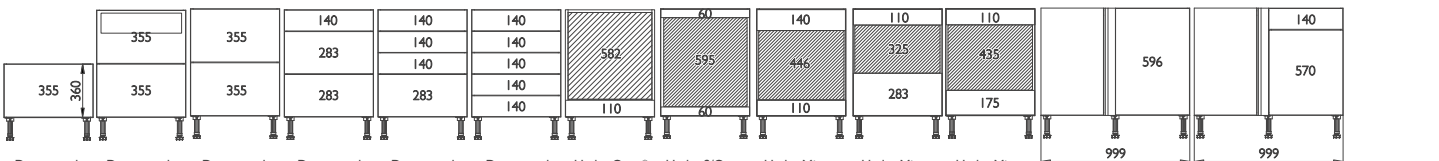

Drawerpack 1473 W500 1474 W600 1475 W900	Drawerpack 2 Drawer 1 Internal 1282 W500 1306 W600 0437 W800 0628 W900 0438 W1000	Drawerpack 2 Drawer 0625 W500 0626 W600 0435 W800 0627 W900 0436 W1000	Drawerpack 3 Drawer 0636 W500 0637 W600 0433 W800 0638 W900 0434 W1000	Drawerpack 4 Drawer 0629 W500 0630 W600	Drawerpack 5 Drawer 0631 W300 0632 W400 0633 W450 0634 W500 0635 W600	Under Oven* 0645 W600	Under S/Oven 0669 W600	Under Micro 0647 W600	Under Micro Pan Drawer 0440 W600	Under Micro Drawer 0441 W600	Corner Base Highline 800W 0648 300W Door 0649 400W Door 0650 500W Door	Corner Base Drawerline 800W* 0657 300W Door 0658 400W Door 0659 500W Door
	Under Sink 1 Pan 1 Sink Drawer 0643 W900		Under Sink 1 Pan, 1 Dummy, 1 Sink Drawer 0644 W900			Bottom Filler* 100mm	Top Filler 60mm Bottom Filler 60mm	Top Filler 140mm Bottom Filler 110mm	Top Filler 110mm Bottom Filler 283mm	Top Filler 110mm Bottom Filler 175mm	Corner Base Highline 900W 0403 445W Door	Corner Base Drawerline 900W* 0411 450W Door
Corner Wall 0899 W600 300 Door 0511 W600 400 Door	Corner Wall 0738 W600 300 Door 0504 W600 400 Door	Corner Wall 0756 W600 300 Door 0543 W600 400 Door	Angled Corner Wall 1450 W630	Angled Corner Wall 0739 W650							Corner Base Highline 1000W 0651 400W Door 0652 500W Door 0653 600W Door	Corner Base Drawerline 1000W* 0660 400W Door 0661 500W Door 0662 600W Door
											Corner Base Highline 1/2 Carousel 1000W/ 0655 500W Door	Corner Base Drawerline Pull Out Carousel 1000W* 0664 500W Door 0665 500W Door
											Corner Base Highline Pull Out Carousel 1000W 0656 500W Door	Corner Base Drawerline 1200W* 0412 600W Door
											Corner Base Highline 1200W 0404 600W Door	

## Pantry Module Height 1970mm 53

2 Door 2 Drawer Pantry	2 Drawer 1 Internal Drawer Pantry	2 Door 3 Drawer Pantry	2 Door 4 Drawer Pantry	1 Door 4 Drawer Pantry
1245 1245	1245 1245	1245 1245	1245 1245	1245
355	355	140 283	175 175	175
355	355	283	175 175	175
			175	175
0330 W600	0331 W600	0332 W600	0333 W600	0334 W600

## Base Unit

Cabinet is supplied pre-notched at the top to accommodate the London Linear (ordered separately).

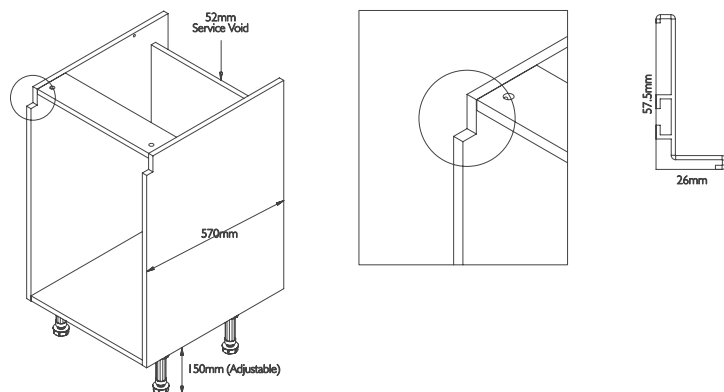

## Drawer Unit

Cabinet is supplied pre-notched at the top to accommodate the London Linear (ordered separately). Lower drawers are supplied with a push to open mechanism.

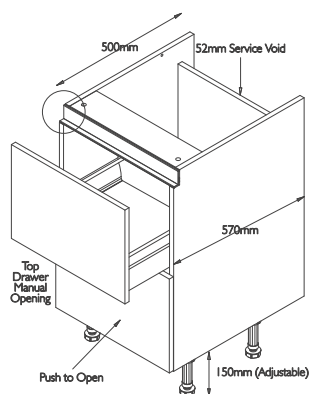

## Wall Unit

Reduced depth bottom panel, to create finger pull for door opening.

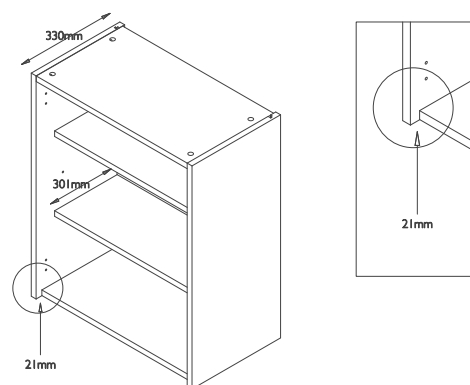

## Tall Unit

Cabinets are supplied with end panel cut back to accommodate the required London Linear.

Cabinets are available to accommodate a single end panel cut back, or double end panel cut back for use where a trim is required on either side.

Single Cut Back - to be ordered as LH and RH hinge unit.

Cut back is supplied opposite to hinge end.

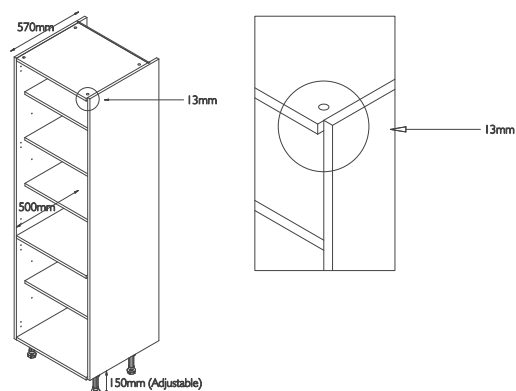

Double Cut Back - to be ordered as LH and RH hinge units, with double cut back.

Both end panels supplied with a cut back. To be used on units with drawers or lift up doors only, as required in kitchen layout/design.

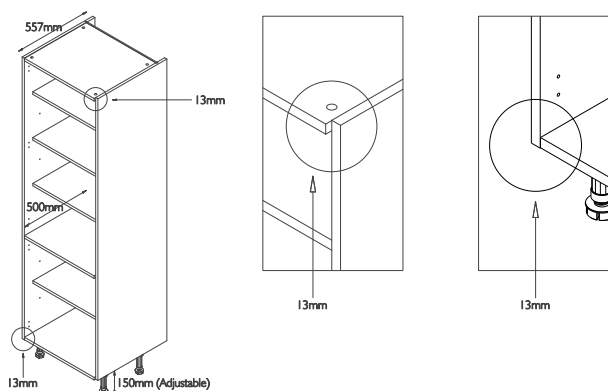

### Single Vertical Profile

ACG3002 & colour.

2600mm length.

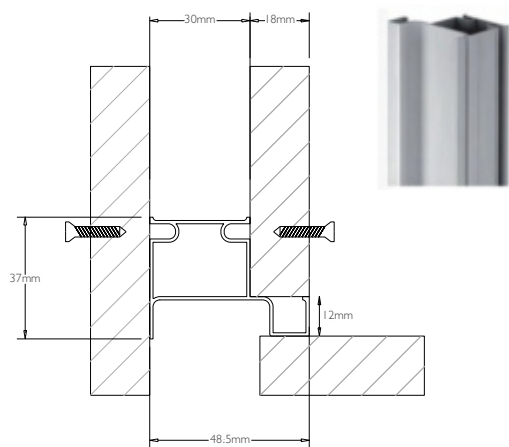

### Double Vertical Profile

ACG3003 & colour. 2600mm length.

To be used where a handle profile is required between two tall units, with access required to either side.

Tall units require a 30mm gap to accommodate vertical profile.

Spacer kit (ACG3998NON) required to install, 2 per profile.

Where double profile used between two tall units, ensure adjacent cabinet end panels are cut back

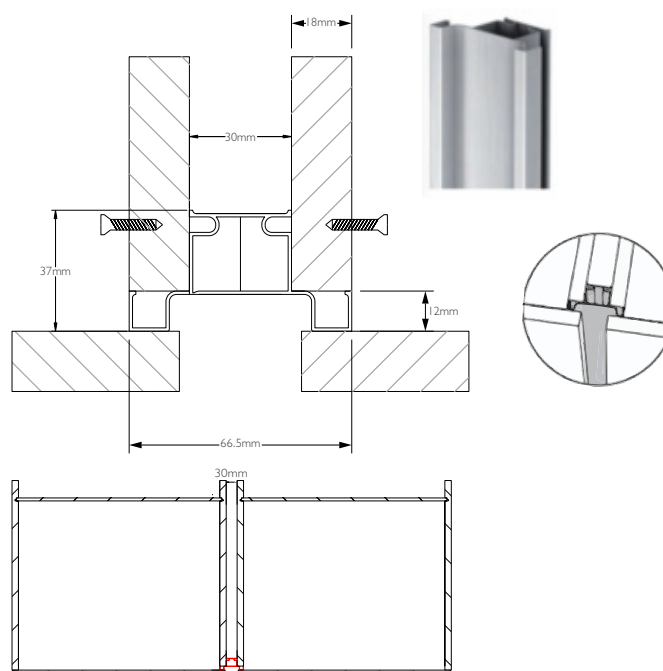

# PURITY PORTFOLIO DELIVERY SERVICE

All of our Purity Portfolio kitchens with the exception of our Premier Plus & Premier Deluxe painted kitchens are available to order on our Week 1 for Week 4 delivery service (our 'cut off' to place your order is 10am on Wednesday of Week 1).

You will need to be a little more patient with our PG8, PG9 & PG10 painted product. We require an additional week's lead time for these, order Week 1 for delivery Week 5. We offer all of our painted options on any of our 9 kitchen ranges highlighted in our Paint to Order section of Purity Portfolio.

## CALL OFF & DELIVERY DATES 2025

Call offs must be received before 10am on Wednesday of Week 1.

	KITCHEN CALL OFF	DELIVERY CAN BE EXPECTED
JANUARY	WC 06 JANUARY WC 13 JANUARY WC 20 JANUARY WC 27 JANUARY	ANYTIME WC 27 JANUARY ANYTIME WC 03 FEBRUARY ANYTIME WC 10 FEBRUARY ANYTIME WC 17 FEBRUARY
FEBRUARY	WC 03 FEBRUARY WC 10 FEBRUARY WC 17 FEBRUARY WC 24 FEBRUARY	ANYTIME WC 24 FEBRUARY ANYTIME WC 03 MARCH ANYTIME WC 10 MARCH ANYTIME WC 17 MARCH
MARCH	WC 03 MARCH WC 10 MARCH WC 17 MARCH WC 24 MARCH WC 31 MARCH	ANYTIME WC 24 MARCH ANYTIME WC 31 MARCH ANYTIME WC 07 APRIL ANYTIME WC 14 APRIL ANYTIME WC 21 APRIL
APRIL	WC 07 APRIL WC 14 APRIL WC 21 APRIL WC 28 APRIL	ANYTIME WC 28 APRIL ANYTIME WC 05 MAY ANYTIME WC 12 MAY ANYTIME WC 19 MAY
MAY	WC 05 MAY WC 12 MAY WC 19 MAY WC 26 MAY	ANYTIME WC 26 MAY ANYTIME WC 02 JUNE ANYTIME WC 09 JUNE ANYTIME WC 16 JUNE
JUNE	WC 02 JUNE WC 09 JUNE WC 16 JUNE WC 23 JUNE WC 30 JUNE	ANYTIME WC 23 JUNE ANYTIME WC 30 JUNE ANYTIME WC 07 JULY ANYTIME WC 14 JULY ANYTIME WC 21 JULY
JULY	WC 07 JULY WC 14 JULY WC 21 JULY WC 28 JULY	ANYTIME WC 28 JULY ANYTIME WC 04 AUGUST ANYTIME WC 11 AUGUST ANYTIME WC 18 AUGUST
AUGUST	WC 04 AUGUST WC 11 AUGUST WC 18 AUGUST WC 25 AUGUST	ANYTIME WC 25 AUGUST ANYTIME WC 01 SEPTEMBER ANYTIME WC 08 SEPTEMBER ANYTIME WC 15 SEPTEMBER
SEPTEMBER	WC 01 SEPTEMBER WC 08 SEPTEMBER WC 15 SEPTEMBER WC 22 SEPTEMBER WC 29 SEPTEMBER	ANYTIME WC 22 SEPTEMBER ANYTIME WC 29 SEPTEMBER ANYTIME WC 06 OCTOBER ANYTIME WC 13 OCTOBER ANYTIME WC 20 OCTOBER
OCTOBER	WC 06 OCTOBER WC 13 OCTOBER WC 20 OCTOBER WC 27 OCTOBER	ANYTIME WC 27 OCTOBER ANYTIME WC 03 NOVEMBER ANYTIME WC 10 NOVEMBER ANYTIME WC 17 NOVEMBER
NOVEMBER	WC 03 NOVEMBER WC 10 NOVEMBER WC 17 NOVEMBER WC 24 NOVEMBER	ANYTIME WC 24 NOVEMBER ANYTIME WC 01 DECEMBER ANYTIME WC 08 DECEMBER ANYTIME WC 15 DECEMBER
DECEMBER	WC 01 DECEMBER WC 08 DECEMBER WC 15 DECEMBER	ANYTIME WC 05 JANUARY ANYTIME WC 12 JANUARY ANYTIME WC 19 JANUARY

## REMEDIAL DELIVERY

A lot of effort is applied to ensure your new kitchen arrives in full and free from damage. We do appreciate, however, on occasions things do not always go to plan. On these occasions it's all about the speed of recovery. Our commitment on our Purity Portfolio offer will be all remedial requests made in Week 1 will be delivered in Week 2.

# OUR USEFUL DOCUMENTS

## CONFIRMATION PROCEDURE

Typical example of our confirmation email

Dear Customer,

### IMPORTANT ACTION FROM YOU REQUIRED

#### Delivery and Installation Schedule Shown Below

*Please note that should your order have installation, this will begin immediately following the delivery, up to a maximum of 7 days after delivery of goods. All plots called off for delivery should be delivered to plot, and ready for install when delivered to avoid abortive or additional costs. Please push back the delivery if this is not possible, and refer to our T&Cs for more details.*

Customer Name:

Site Name:

### DEFINITIONS

**Week 2 Delivery & Installation Schedules – NO ACTION REQUIRED** - We are no longer able to amend the Week 2 scheduled deliveries. All are now in production following your previous acceptance of the schedule, this email is simply to confirm the day of delivery.

**Week 3 Delivery & Installation Schedules – ACTION REQUIRED** - We require confirmation that you are ready for the Week Commencing installation date confirmed. If we do not receive positive confirmation by Thursday 12pm of this week, your orders will automatically be delayed by 1 week. It will not be possible to pull delivery dates forward once we have taken this action.

**Week 4+ Delivery & Installation Schedules – ACTION REQUIRED**

#### WEEK 2 DELIVERY SCHEDULE

Delivery Status	Week No.	Date Due	Plot	Order Type	Customer Order No.	Order No.
FIXED	2	25-Oct	PL100	KIT	10000	111

#### WEEK 3 DELIVERY SCHEDULE

##### ACTION REQUIRED BY CUSTOMER

**PLEASE CONFIRM ACCEPTANCE OF DELIVERY DATES BY THURSDAY 12 NOON BY E-MAIL. NO DELIVERIES WILL TAKE PLACE WITHOUT YOUR APPROVAL. IF NO RESPONSE THE DELIVERY DATE WILL BE DELAYED BY ONE WEEK.**

Delivery Status	Week No.	Week Commencing	Plot	Order Type	Customer Order No.	Order No.
Option	3	30-Oct	PL200	KIT	10001	112

#### WEEK 4 DELIVERY SCHEDULE

##### ACTION REQUIRED

Delivery Status	Week No.	Week Commencing	Plot	Order Type	Customer Order No.	Order No.
Option	4	06-Nov	PL229	KIT	10002	113

Please refer to our terms and conditions for more specific information relating to our delivery service.

We would however draw your attention to the following:

- In the event our delivery is stored in an alternative plot OR unfinished kitchen area or alternate room within the property but not the kitchen or room adjacent to the kitchen - these goods become the sole responsibility of the customer.
- Security on site for all delivered goods is the responsibility of the customer.
- Our delivery team require clear and safe access from the delivery vehicle to the plot, failed delivery charges may apply if this is not possible.
- Failed deliveries are subject to a redelivery & storage charge.

Kind Regards,

The Richmond Customer Service Team

# KERBSIDE DELIVERY FORM

Typical example of our kerbside delivery form

# PURITY

BY RICHMOND FURNITURE

## YOUR DETAILS

Your Address:

Your Point of Contact:

Postcode:

Customer Order No:

## KERBSIDE DELIVERY DETAILS

Name:

Home Telephone:

Address:

Mobile:

Email:

Postcode:

## DELIVERY DETAILS PLEASE ENSURE YOUR CUSTOMER IS AWARE THAT DELIVERY WILL BE MADE BETWEEN 8AM & 4PM (KERBSIDE DELIVERY ONLY)

If the answer to any of the questions below is 'NO' or these details are 'NOT ACCEPTABLE' to you, you must provide as much detail as possible in the Customer Response section to help us understand the issue. Please be aware in the event you record as 'NO' or 'NOT ACCEPTABLE' it will be necessary to organise a SPECIAL REQUEST delivery from Purity by Richmond Furniture. Our Customer Service Team will make you aware of any additional costs and impact on lead time.

QUESTION	CUSTOMER RESPONSE
1. Purity Xpress day of delivery is known at the point of order. For Purity Portfolio; we will provide week commencing delivery dates, and will advise you of the day of delivery the week prior.	
2. Can a large vehicle, such as a standard refuse vehicle, gain unimpeded access to the address?	
3. Can our vehicle park to offload with no restrictions at the address?	
4. Can our vehicle be stationary for approximately one hour without causing an obstruction during the unload?	
5. Is the delivery to a ground floor property with less than 4 steps into the property?	
6. Can we park the vehicle within 20 metres of the unload address?	
7. In the event your delivery includes full length worktops, is there a suitable place to store or locate these (to allow you to take into the property after our departure)?	
8. Will the customer be present or have an authorised person present to sign and check no packaging damaged at point of delivery?	
9. You understand; once a delivery is confirmed, should the delivery fail due to the customer not being available or not meeting the criteria set out above, redelivery charges may apply. Please see terms & conditions.	

## RFL Office Use ONLY

Order No:

Delivery Service: **KERBSIDE DELIVERY ONLY**

Estimated Delivery Date:



[www.richmond-furniture.co.uk](http://www.richmond-furniture.co.uk)

Richmond Furniture Ltd, Regent House, Hadfield Ind. Est, Waterside, Hadfield, Glossop, SK13 1BS

PURITY

49

# ORDER CHECKING SHEET

Typical example of our order checking sheet

# PURITY

BY RICHMOND FURNITURE

Account Code:		Order No:		Address:	
Customer Name:		Route Name:			
Site Name:		Inputter:			
Plot:		Order Type:			
Date Entered:		Delivery Method:			
Date Required:		Pricing Method:		Postcode:	
Customer Order No:					

L#	Alpha Filler Level	Quantity	Hand	Décor Colour	Unit Description	Range Description	Fascia Colour	Carcass Type	Carcass & Drawer Colour Feat & Acc Colour	Disc	Value
1											
2											
3											
4											
5											
6											
7											
8											
9											
10											
										Total	£



# ACCOUNT APPLICATION FORM

Typical example of our account application form

# PURITY

BY RICHMOND FURNITURE

## CUSTOMER MUST COMPLETE ALL SECTIONS IN BLUE

Company Registration Number:	
Company Name:	
Account Contact:	
Telephone:	
Invoice Email:	

Customer Sales Contact:	
Telephone:	
Order Confirmation Email:	
Registered Office:	
	Postcode:
Invoice / Statement Address:	
	Postcode:
Default Delivery Address:	
	Postcode:

Anticipated Credit Limit Required or Pro-Forma?	
Which regions of the UK do you carry out work?	

## TYPE OF BUSINESS Mark 'x' as appropriate

<input type="checkbox"/> Independent Retailer (Purity Portfolio)	<input type="checkbox"/> Merchant Buying Group (Purity)	<input type="checkbox"/> Distributor (Purity Xpress & Purity Portfolio)
<input type="checkbox"/> Builders Merchant (Purity)	<input type="checkbox"/> MHK UK Group Member (Purity Portfolio)	

MHK UK Membership Number:	
---------------------------	--

Your Richmond Furniture Contact:	KARL PICKWICK
----------------------------------	---------------

## DELIVERY METHOD

On P23 of this brochure it confirms the postcode which are delivered on Richmond Fleet Delivery or Palletised Delivery. A number of postcodes have the option of either service. If your post code offers the choice of either service please confirm below your preference. Can we remind you that our palletised service requires the use of a fork lift. Your Delivery Service Preference:

<input type="checkbox"/> Richmond Fleet Delivery	<input type="checkbox"/> Palletised Delivery
--	--

We, the undersigned, have read and agree to abide by the terms and conditions of Richmond Furniture Limited in relation to the supply of goods and services. We agree that all goods remain the property of Richmond Furniture Limited until paid for in full. If the company is trading as a Partnership then all partners must sign this form. If the company is Limited the form must be signed by a director.

Sign:		Sign:	
Date:		Date:	
Print Name:		Print Name:	
Position:		Position:	

## THIS SECTION TO BE COMPLETED BY RICHMOND FURNITURE Credit Admin

Type of Customer:	
Customer Reg No:	
Sage Customer Account No:	
Discount:	
Price File:	RP7 & RI7



[www.richmond-furniture.co.uk](http://www.richmond-furniture.co.uk)

Richmond Furniture Ltd, Regent House, Hadfield Ind. Est, Waterside, Hadfield, Glossop, SK13 1BS

PURITY 51

# CALL OFF SHEET

Typical example of our call off sheet

# PURITY

BY RICHMOND FURNITURE

Company:

Site Name:

Site Manager:

Telephone:

Email:

Site Address:

Postcode:

Special Instructions:

*Cut off for orders is Wednesday 10pm*

Plot No	RFL Drawing Ref	Customer House Type	Date Required*

\*Order Week 1 for Delivery Week 4

MAIN KITCHEN					
Handing: AS/OP	Range & Fascia Colour	Feature / Accessory Colour	Worktop Colour	Sink / Tap Option	Handle Choice

UTILITY						
Handing: AS/OP	Range & Fascia Colour	Feature / Accessory Colour	Worktop Colour	Sink / Tap Option	Handle Choice	Plot Specific Instructions

Call Off Completed By:

Date:



[www.richmond-furniture.co.uk](http://www.richmond-furniture.co.uk)

Richmond Furniture Ltd, Regent House, Hadfield Ind. Est, Waterside, Hadfield, Glossop. SK13 1BS

# QUOTATION REQUEST FORM

Typical example of our quotation request form

# PURITY

BY RICHMOND FURNITURE

Completed By: \_\_\_\_\_  
Date Completed: \_\_\_\_\_

## CUSTOMER DETAILS

Customer (full name): \_\_\_\_\_  
Customer (full address): \_\_\_\_\_

## TYPE OF CUSTOMER

☐ Independent Retailer (Purity Portfolio) ☐ Merchant Buying Group (Purity) ☐ Distributor (Purity Xpress & Purity Portfolio)  
☐ Builders Merchant (Purity) ☐ MHK UK Group Member (Purity Portfolio)

## PROJECT INFORMATION

Project Name: \_\_\_\_\_  
Project Location: \_\_\_\_\_  
Project Postcode: \_\_\_\_\_  
No. of Plots (on this project): \_\_\_\_\_  
Customer Contact Name: \_\_\_\_\_  
Customer Contact Telephone: \_\_\_\_\_  
Customer Contact Email: \_\_\_\_\_  
Requested Quote Return Date (Please allow 15 working days): \_\_\_\_\_

## DELIVERY & INSTALLATION INFORMATION

Supply Only or Supply & Install (dry installation only): \_\_\_\_\_  
Confirm if 2 person offload team required: \_\_\_\_\_  
Installation only available if project is 10 plots or greater  
Supply only projects available on kerbside delivery only

## IMPORTANT INFORMATION

Plans: \_\_\_\_\_ Please provide a copy of competitor plans if possible  
Quotation Specifications: \_\_\_\_\_ Please provide a copy of competitor quote or listing

## KITCHEN SELECTION

Kitchen Collection: \_\_\_\_\_ Select Purity Xpress or Purity Portfolio  
Confirm all ranges or PG's to be included in your quotation:  
Base Unit Type (Drawerline or Highline with Drawer Pack): \_\_\_\_\_  
If Highline with Drawer Pack, confirm number of Drawers: \_\_\_\_\_  
Do you require a Boiler Housing in the Kitchen? \_\_\_\_\_ Confirm make and model of boiler  
Do you require a Boiler Housing in the Utility? \_\_\_\_\_ Confirm make and model of boiler  
If not confirmed, we will assume 900mm x 400mm suits  
If you do not have boiler details, confirm preferred housing: \_\_\_\_\_  
Wall Unit Height: \_\_\_\_\_ Confirm 575mm, 720mm or 900mm

There are 4 Purity options, please confirm which you wish quoted: \_\_\_\_\_ Only complete below for the option you want quoted

## PURITY XPRESS

Confirm Cabinet colour required: \_\_\_\_\_ Choose White or Onyx  
Confirm Drawer System required: \_\_\_\_\_ Choose Premier (White) or Premier Plus (Anthracite)  
If Premier Drawer, do you require brake system (soft close)? \_\_\_\_\_ Premier Plus comes with soft closing drawer system  
Do you require Soft Close Attachments for Door Hinges? \_\_\_\_\_  
Do you require Gable Ends? \_\_\_\_\_ These will be colour or frontal matched (refer to brochure)  
Do you require Plant on Panels rather than Gable Ends? \_\_\_\_\_ These will be frontal matched (except Downey)  
Which Handle(s) do you wish to include in the quote? \_\_\_\_\_

## PURITY XPRESS VICINO

Confirm Cabinet colour required: \_\_\_\_\_ ONYX Only available in Onyx  
Confirm Drawer System required: \_\_\_\_\_ PREMIER PLUS Premier Plus (Anthracite) as standard  
Do you require Soft Close Attachments for Door Hinges? \_\_\_\_\_  
Do you require Gable Ends? \_\_\_\_\_ These will be colour or frontal matched refer to brochure  
Do you require Plant on Panels rather than Gable Ends? \_\_\_\_\_ These will be frontal matched (except Downey)  
Which colour Gola Rail and InLine handle system is required? \_\_\_\_\_ Available in Silver or Anthracite

## PURITY PORTFOLIO

Confirm Cabinet colour required: \_\_\_\_\_ Choose White, Onyx or Oak  
Confirm Drawer System required: \_\_\_\_\_ PREMIER DELUXE Premier Deluxe (Anthracite) as standard  
Plant on Panels supplied as standard: \_\_\_\_\_ PLANT ON PANELS  
Which Handle(s) do you wish to include in the quote? \_\_\_\_\_

## PURITY PORTFOLIO LONDON LINEAR

Confirm Cabinet colour required: \_\_\_\_\_ Choose White, Onyx or Oak  
Confirm Drawer System required: \_\_\_\_\_ PREMIER DELUXE Premier Deluxe (Anthracite) as standard  
Plant on Panels supplied as standard: \_\_\_\_\_ PLANT ON PANELS  
Which colour Gola Rail system required? \_\_\_\_\_ Available White, Silver, Black or Anthracite

## WORKTOP OPTIONS

Purity Xpress (only available 38mm Premier Deluxe - 3mm radius): \_\_\_\_\_ PG2 38mm Premier Deluxe - 3mm radius  
Purity Portfolio (select from options below):  
☐ PG2 38mm Premier Deluxe - 3mm radius ☐ PG4 38mm Premier Plus square edged ☐ PG5 22mm Premier Deluxe square edged  
Are Upstands required? \_\_\_\_\_  
Is Splashback behind the Hob required? \_\_\_\_\_ Stainless Steel or Glass? \_\_\_\_\_  
Do you require Jointing Bolts or Jointing Strips? \_\_\_\_\_  
Do you require Joint Colour Filler? \_\_\_\_\_

## ACCESSORY INFORMATION

Confirm if traditional Cornice is required? \_\_\_\_\_  
Confirm if traditional Light Pelmet is required? \_\_\_\_\_  
Confirm if 18mm modern LPI/Cornice is required? \_\_\_\_\_  
Confirm if Units are to be fully framed? \_\_\_\_\_  
Confirm if Plinth seals are required? \_\_\_\_\_  
Confirm if Lights are required (add detail below)? \_\_\_\_\_  
Confirm if Locks are required (add detail below)? \_\_\_\_\_  
Confirm if Sink Liner is required? \_\_\_\_\_  
Confirm if Hob Heat Shield is required? \_\_\_\_\_  
Confirm if Cutlery Tray is required? \_\_\_\_\_  
Confirm if Kitchen Protection is required? \_\_\_\_\_  
Confirm if Ducting Kit is required? \_\_\_\_\_  
Confirm if Bin is required (add detail below)? \_\_\_\_\_  
Confirm any other requirement below: \_\_\_\_\_

## SINKS & TAP INFORMATION

If providing your own sink and tap please leave blank  
Sink Model No: \_\_\_\_\_ Kitchen: \_\_\_\_\_ Utility: \_\_\_\_\_  
Tap Model No: \_\_\_\_\_ Kitchen: \_\_\_\_\_ Utility: \_\_\_\_\_

## APPLIANCE INFORMATION

If Richmond are not providing the appliances, you only need to complete the columns headed 'RICHMOND OR BY OTHER' and 'INFORMATION'. In the 'INFORMATION' column please provide a brief description and confirm if integrated or free standing (e.g. washer free standing):

APPLIANCE CATEGORY	RICHMOND OR BY OTHER	MANUFACTURER	MODEL NUMBER	INFORMATION
Oven				
Microwave				
Oven / Microwave Combo				
Hob				
Hood				
Wine Cooler				
Fridge / Freezer				
Dishwasher				
Washer				
Washer Dryer				
Tumble Dryer				
Coffee Machine				
Other				

## DRAWING INFORMATION

If you have not provided a competitors drawing, please provide some details relating to design look required below:

Do you require 3D perspectives or just floor plans? \_\_\_\_\_  
If 3D perspectives required, confirm kitchen range to be used: \_\_\_\_\_ Confirm colour to be used: \_\_\_\_\_  
If 3D perspectives required, confirm worktop range to be used: \_\_\_\_\_ Confirm colour to be used: \_\_\_\_\_

Confirm names of all house types & number of plots for each:	House Type	Plot Quantity	House Type	Plot Quantity	House Type	Plot Quantity
	House Type	Plot Quantity	House Type	Plot Quantity	House Type	Plot Quantity
	House Type	Plot Quantity	House Type	Plot Quantity	House Type	Plot Quantity

## ADDITIONAL NOTES

Confirm who the quotation is to be sent to: \_\_\_\_\_



www.richmond-furniture.co.uk

Richmond Furniture Ltd, Regent House, Hadfield Ind. Est, Waterside, Hadfield, Glossop. SK13 1BS

PURITY 53

# OUR IMPORTANT BITS

---

## WELCOME ON BOARD

- ◆ Our National Sales Manager will introduce you to all things Purity by Richmond Furniture and present your personalised Welcome to Purity brochure.

## NEW ACCOUNT PROCESS

- ◆ All customers will complete a Purity by Richmond Furniture account application form and submit this to our National Sales Manager and Credit Control Department.
- ◆ Our Credit Control Department will complete the necessary credit check and where credit is available, this will be advised to both our National Sales Manager and customer.

*Please allow sufficient time for this process to take place before placing your first order, we normally require 48 hours. If more urgent our National Sales Manager will be happy to expedite. Our standard lead times are applicable from the point your account is open and order fully completed in our possession.*

## CREDIT ACCOUNT

- ◆ Our payment terms are 30 days net monthly at the confirmed credit limit.
- ◆ In a situation where orders on the system breach the agreed credit limit it may be necessary for our customer to make a payment on account.

## PRO FORMA ACCOUNT

- ◆ Payable to **Lloyds Bank, Richmond Furniture Limited**, Account Number **82966960**, Sort Code **30-95-42**
- ◆ We are only able to process orders on receipt of cleared funds. Our standard lead times apply from the point we have cleared funds.

## DELIVERY

- ◆ On our free of charge kerbside deliveries, it is the responsibility of the customer to take the goods into their property. Our driver is not insured to do so.
- ◆ In the event we have scheduled the delivery with your customer but the customer is not then available to accept the delivery, Purity by Richmond Furniture will contact the relevant merchant branch or retailer to offer the opportunity for the delivery to be redirected to their premises. If this is not possible a redelivery charge of £150 will be charged. This would apply to each and all aborted deliveries.

## REMEDIAL DELIVERY

- ◆ Remedial deliveries to home address destinations are always offered only as kerbside delivery. The customer will be responsible for taking the delivery into their property our Customer Service Team will advise your customer of the day of delivery. In the event the delivery fails due to the customer not being available charges may apply.

## DESIGN AND QUOTATIONS

- ◆ All projects involving single plots should be priced using our KBB Connect facility.
- ◆ For all projects involving 10 or more plots, we will be happy to offer the services of our Estimating Team. You will need to complete a Quotation Request Form or QRF (refer to example on page 44) to ensure we have all the necessary information. Your designs and estimates will be returned to you within 15 working days of receipt of the QRF document.

## FAST TRACK DELIVERIES

The prices we submit for your kitchen furniture includes for kitchen and remedial deliveries providing you use our guaranteed postcode delivery service (refer to page 23). The only exception to this would be where our customer wishes to place orders outside of this requiring a Fast Track Delivery Service. We know on occasions you may need this service for those little emergencies, when you do we will be happy to organise this for you. Details of the associated costs are below. All services are dependent on stock availability.

You can save yourself the expense of delivery by using our Purity Xpress Delivery Vehicle (it's free!). Refer to page 23. However, should you wish an even faster service for those little emergencies then we will be happy to organise this for you. Details of the associated costs are below. All services are dependent on stock availability.

PARCEL ORDERS UNDER £250			
CUSTOMER GROUP	CODE	SERVICE	PRICE (ex VAT)
All		Purity Xpress Delivery Service Vehicle*	FOC
All	DEL001	1-3 Day Service	£16.95
All	DEL002	24 Hour Service	£42.75

PALLET SERVICE			
CUSTOMER GROUP	CODE	SERVICE	PRICE (ex VAT)
All		Purity Xpress Delivery Service Vehicle*	FOC
All	DEL005	Standard Euro (1200mm x 800mm)	£144.53
All	DEL004	Super Pallet (2400mm x 1200mm)	£255.00

\*We require 72 hours notice to achieve the next Purity Xpress Delivery Service Vehicle.

## REDELIVERY

We will organise your delivery and confirm the date you will receive your quality Purity Kitchen. It is important, once organised, to ensure your customer is ready to accept our delivery. We will call on the day of delivery as a polite reminder of the delivery. This will help prevent any of the redelivery, storage or offload charges.

REDELIVERY CHARGE			
CUSTOMER GROUP	CODE	SERVICE	PRICE (ex VAT)
All		Failed Delivery - Redelivery	£150.00
All		Failed Delivery - Storage per week	£50.00

## DISPLAY SUPPORT

We will offer a maximum of 5% of your agreed sales target. Our National Sales Manager will be happy to formalise the agreement.

As an example:

- 💧 If your agreed annual target was £50,000 you would be supported by a credit against your display purchases to the value of £2,500. The displays would be paid for with credit due after the first 12 months of trading.
- 💧 If your agreed annual target was £100,000 you would be supported by a credit against your display purchases to the value of £5,000. The displays would be paid for with credit due after the first 12 months of trading.
- 💧 All displays will be provided at a preferential display discount of 70%.

## SAMPLES

- ◆ All sample products equal to or less than £40 will be supplied on a FOC basis. Any sample products £41 or above will be chargeable but credited in full against your first order with Purity.
- ◆ It will be necessary to have a credit account to take advantage of any FOC samples.
- ◆ Once your sample account is established, you can then order your quality samples using our KBB Connect service or via your National Sales Manager.
- ◆ Your samples will then be sent to you on a FOC basis on our agreed terms.

## HELPFUL REMINDERS

- ◆ PALLETISED DELIVERY – Can be offered to all postcodes.
- ◆ PALLETISED DELIVERY – Customer must have means to offload (forklift truck).
- ◆ RICHMOND FLEET DELIVERY – Kerbside delivery offered but restricted postcodes (refer to page 23).
- ◆ CORNER POST SOLUTION – As standard 'Frontal Matched,' this is a 196mm x 720mm panel that requires a cut to form corner post.
- ◆ OPEN UNITS – We supply in a choice of 3 colours : Taupe, Onyx and Oak.

# OUR SMALL PRINT, THAT'S NOT TOO SMALL

---

## PRODUCT GUARANTEE

Purity by Richmond takes every care when manufacturing furniture to ensure that products are produced to a high standard, and we are confident that the look and use of our products will continue for many years. However, should you discover a defect in any of our products within 5 years of the product being delivered to you, we will carry out an investigation and replace any defective components free of charge.

## REQUIREMENTS

The furniture has been correctly designed, installed, and maintained and is located in the UK;

- 💧 You notify us in writing as soon as reasonably practical (and in any event within 28 days) after discovery of the defect (enclosing a dated proof of purchase) and permit our representatives to safely inspect the furniture.
- 💧 The furniture has not been repaired or altered by any person not authorised by us.
- 💧 The furniture has not been used on a commercial basis.
- 💧 Proof of purchase is retained for the lifetime of the guarantee.

This guarantee covers any replacement components, which are covered by the remaining period of the original guarantee only. A separate guarantee period is not created for the replacement products as a result of their supply to you.

We reserve the right to substitute materials of a similar type if the materials or components requiring replacement are not readily available or are discontinued.

Electrical goods, worktops, sinks and taps (plus any other product which a third party guarantee is provided) are covered by a separate product guarantee, provided by the manufacturer of these products.

The guarantee is conferred upon the original purchaser of the products, and cannot be transferred to another person.

## EXCLUSION

The guarantee does not include:

- 💧 General wear and tear or alteration.
- 💧 Scratches on gloss or painted finishes and other components arising from everyday use.
- 💧 Repair or installation by a person not authorised by us.
- 💧 Misuse, damage or negligent use.
- 💧 Failure to follow our guidelines concerning maintenance.
- 💧 Commercial use of products.
- 💧 Export from the United Kingdom without agreement.

Some component parts are made from natural materials, some are man made to replicate natural materials, and they may change in the ordinary course of their lifespan. This may affect the look and feel of the products, and as such are not considered defects, and include without limitation:

- 💧 Slight difference in the colour as materials often reflect light differently.
- 💧 Woodgrain patterns on manufactured or natural products that are not uniform.
- 💧 Product that have mellowed or changed colour in sunlight.
- 💧 Products that have failed as a result of ingress of moisture.
- 💧 Products that have failed due to excessive heat.

The above guarantee is in addition to and does not affect your statutory rights.



## OUR PRODUCT



## MANUFACTURED RIGHT HERE IN THE UK

We have everything you need for your new kitchen including sinks and taps from the leading UK manufactures, modern lighting in the 'must have' and 'nice to have' models, European wirework that makes great use of our Purity cabinetry to add those practical but eye catching elements to your finished kitchen.

*We look forward to being of service!*

# PURITY

BY RICHMOND FURNITURE

# PURITY

BY RICHMOND FURNITURE

## WELCOME ON BOARD

CUSTOMER NAME			
PRESENTED TO		PRESENTED BY	
CUSTOMER ACCOUNT NO		AGREED DISCOUNT	
CUSTOMER SIGNATURE			
SIGNED ON BEHALF OF PURITY BY RICHMOND			

# Richmond

●●●●● FURNITURE

Richmond Furniture Ltd, Regent House,  
Hadfield Industrial Estate, Waterside,  
Hadfield, Glossop SK13 1BS

t: 01457 767000  
e: [info@richmond-furniture.co.uk](mailto:info@richmond-furniture.co.uk)  
w: [www.richmond-furniture.co.uk](http://www.richmond-furniture.co.uk)

For more information about any of our brands, please contact the above.



**INFINITY**  
BY RICHMOND FURNITURE

**REGENCY**  
BY RICHMOND FURNITURE

**PURITY**  
BY RICHMOND FURNITURE

**LIBERTY**  
BY RICHMOND FURNITURE

**EIGHTY**  
BY RICHMOND FURNITURE